



MEGA
CHAINS & ROPES

MEGA LINK CHAINS (INDIA) LTD.

Linking Safety, Strength & Reliability

Hoist and Riggings

OUR STORY

Established in 1996 as the leading manufacturers & exporters of Lifting chains of Grade 80, Grade 100, S.S. Chains, Steel wire ropes, Deep ocean trawler fishing ropes & Lifting tackles. MEGA proudly states that we are the only one in India to manufacture all these products under one roof.

MEGA is an Indian multinational having 3 state-of-the-art manufacturing facilities, two in India each for Link Chain & Steel Wire Ropes, we also have a most modern manufacturing facility in Jinhua, China. Setting new global standards in high-quality link chains and wire ropes. Rooted in innovation, reliability & safety, we empower industries with precision-engineered solutions that enhance efficiency & drive progress. Through cutting-edge technology & strong client partnerships, we are forging a future where strength, performance & trust create lasting impact worldwide.

Backed by over 30 years of industry trust, Leading the way in innovation, we engineer world-class chains, wire ropes and accessories with cutting-edge technology and continuous improvement. Committed to international quality standards, we enhance efficiency, safety & performance across industries. Proudly driving the Make in India initiative, we are transforming India into a global powerhouse for high-quality lifting and rigging solutions, delivering reliability and excellence to the world.

"From a bold vision in 1996 to a global force today—our true strength lies in unmatched quality, unwavering reliability & the enduring bonds we forge with our clients. Together, we don't just build; we elevate industries, empower progress & shape a future of excellence!"



INDEX

Pg. 1	Our Story	Pg. 36	G100 Eye Shortening Grab Hook G100 Clevis Grab Hook G100 Clevis Chain Clutch With Shelf Pin
Pg. 3	Our Culture	Pg. 37	G100 Large Opening Eye Hook G100 Clevis Large Opening Hook
	HOIST		G80 COMPONENTS
Pg. 5	Production Site	Pg. 39	G80 Connecting Link G80 Clevis Chain Clutch
Pg. 6	DH Manual Lever Hoist Make by Standard: EN13157	Pg. 40	G80 Clevis Chain Clutch G80 Omega Ring G80 Twist Eye Choke Hook
Pg. 7	VA Manual Lever Hoist Make by Standard: EN13157	Pg. 41	G80 Clevis Large Opening Hook G80 Large Opening Eye Hook G80 Eye Locking Hook
Pg. 8	DKS Subsea Chain Hoist Make by Standard: EN13157/ASTM117	Pg. 42	G80 Clevis Self Locking Hook G80 Swivel Self Locking Hook with Bearing G80 Swivel Self Locking Hook with Bushing
Pg. 9-10	DF Manual Chain Hoist Make by Standard: EN13157	Pg. 43	G80 Clevis Sling Hook with Latch G80 Eye Sling Hook with Latch G80 Clevis Sling Hook Large Format
Pg. 11	SLA Manual Chain Hoist Make by Standard: EN13157	Pg. 44	G80 European Type Eye Grab Hook with Safety Hook G80 Clevis Sling Hook Large Format G80 Eye Shortening Grab Hook
Pg. 12	YTG Low Headroom Hoist Make by Standard: EN13157	Pg. 45	G80 Container Hook Wide Mouth Hook G80 Eye Tube Hook G80 Clevis Tube Hook
Pg. 13	Electric Hoist With Hook	Pg. 46	G80 Eye Hook G80 Eye Hook (Italian Type) G80 Swivel Hook with Bearing
Pg. 14	Electric Trolley	Pg. 47	G80 Swivel Hook with Latch G80 Swivel Hook with Bearing G80 Swivel Hook with Bushing
Pg. 15	3.2~20ton Single Girder Wire Rope Hoist	Pg. 48	G80 Container Lifting G80 Clevis Choke Hook
Pg. 16-18	Lifting Clamp DLD Universal Lifting Clamp DPD Horizontal Lifting Clamp DPH Pipe Lifting Clamp DVC Vertical Lifting Clamp DLC Horizontal Lifting Clamp Beam Clamp Make By Standard: En13157	Pg. 49	A342 Forged Alloy Master Links
Pg. 19	DYC Lifting Clamp/DML Series Permanent Magnetic Lifter DYC Beam Clamp DML Series Permanent Magneteic Lifter	Pg. 50	A343 European Type Master Link with Flat A344 Us Type Master Link (Welded)
Pg. 20-21	DSL Iron Wire Rope Pulley Machine DYC Beam Clamp DSL Aluminium Wire Rope Pulley Machine DSL-TW800 DSL-TW1600 DSL-TW3200 DSL-TW5400	Pg. 51	G80 Master Link A345 US Type Master Link Assembly
Pg. 22	DTK Roller Skate/Dme Hydraulic Bottle Jack DTK Roller Skate DME Hydraulic Bottle Jack	Pg. 52	A346 Master Link Assembly with Flat
Pg. 23	DLSYC-A Manual Stacker	Pg. 53	A347 Us Type Master Link Assembly (Welded) G80 Master Link Assembly Type
Pg. 24	Semi-Electric Stacker	Pg. 54	G80 Clevis Pear Link G80 Weldless Round Rings
Pg. 25	Hand Pallet Truck DLT Hand Pallet Truck DNBJ Hand Pallet Truck	Pg. 55	G80 Forged Pear Shape Link G80 Wide-Body Shackle
Pg. 26-27	Manual Trolley DTP Type Plain Trolley DTG Type Grade Trolley DAP Type Plain Trolley DTDG Type Geared Trolley DTDP Type Plain Trolley	Pg. 56	Sorting Hook Sorting Hook with Handle G80 Lashing Type C Hook with Spring Pin G80 Chain Link
	G100 COMPONENTS	Pg. 57	DEE Shackles BOW Shackles
Pg. 29	G100 Integrated Shortening Hook G100 Integrated Shortening Hook Assembly with Master Link 1-LEG, 2-LEG		RIGGINGS
Pg. 30	G100 Integrated Shortening Hook Assembly with Master Link 4-LEG G100 Master Link G100 Master Link Assembly	Pg. 59	Shackle Type Heavy Duty Snatch Block
Pg. 31	G100 Connecting Link G100 Eye Self Locking Hook	Pg. 60	HY General Block U.S Type Forged Turnbuckle (Hook & Eye Hook & Hook)
Pg. 32	G100 Eye Self Locking Hook with Hidden Trigger G100 Clevis Self Locking Hook G100 Clevis Self Locking Hook with Hidden Trigger	Pg. 61	U.S Type Forged Turnbuckle (Eye & Eye, Jaw & Eye, Jaw & Jaw)
Pg. 33	G100 Swivel Self Locking Hook with Bearing G100 Swivel Self Locking Hook with Bushing G100 Swivel Self Locking Hook with Bearing with Hidden Trigger	Pg. 62	Turnbuckle DIN 1480 Turnbuckle Frame Type (Forged Steel)
Pg. 34	G100 Swivel Self Locking Hook with Bushing with Hidden Trigger G100 Clevis Sling Hook with Latch G100 Eye Sling Hook with Latch	Pg. 63	U.S. Type Drop Forged Steel Wire Rope Clips DIN1142 Malleable Wire Rope Clips
Pg. 35	G100 Clevis Shortening Grab Hook G100 Eye Shortening Grab Hook G100 Clevis Shortening Grab Hook	Pg. 64	DIN741 Malleable Wire Rope Clips U. S. Type Malleable Wire Rope Clips
		Pg. 65	Eye Screw DIN580
		Pg. 66	Ring Nut DIN582

1
HOIST

2
G100 COMPONENTS

3
G80 COMPONENTS

4
RIGGING HARDWARE

COMPANY CULTURE

Mega Link Chains (India) Ltd. fosters a strong culture built on safety, quality, and sustainability. The company prioritizes safe working practices, enforces rigorous quality standards, and integrates responsible resource management across every stage of manufacturing.

With disciplined processes and continuous improvement, it ensures reliable performance, safeguards people and the environment, and creates lasting value for customers, employees, and industry partners alike.





HOIST

PRODUCTION SITE



DH MANUAL LEVER HOIST

MAKE BY STANDARD: EN13157

- Lever hoist capacity range from 0.75 ton to 9 ton.
- Ergonomic handle design so that the hoist is easy to operate, product suitable for all application.
- Suspension and load hooks are made of alloy steel 35CrMo, heat treated and fitted with heavy duty safety latches fitting groove and inspection points.
- Machined chain sprocket and gears provide smoother, more efficient operation.
- Hook with safety latch securely can rotate freely 360 degrees.
- Gears are made up of 20CrMnTi, material which ensures toughness and better strength.
- Fitted with high strength grade 80 alloy steel load chain with galvanized finish for comasion resistance, (comply with EN 818-7, safety factor 4).
- Load chain marked with 18 marks as per EN 838-7.
- Heavy duty guide rollers for avoiding sippage of load chain.
- Nyion pull ring
- All hoists tested at 1.5 times of WLL

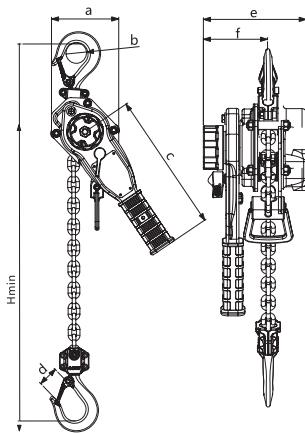

DH 0.75-3T

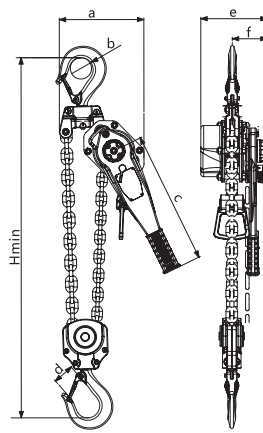

DH 6T

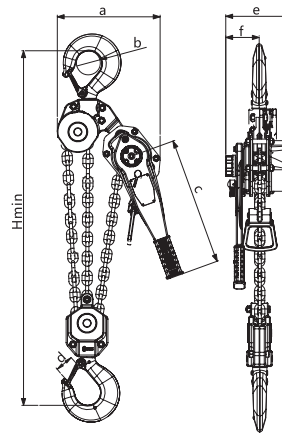

DH 9T

Model		DH-0.75T	DH-1.5T	DH-3T	DH-6T	DH-9T
Capacity load	(t)	0.75	1.5	3	6	9
Standard lift	(m)	1.5	1.5	1.5	1.5	1.5
Laod chain Number of falls		1	1	1	2	3
Effort required to lift max load	(N)	220	240	330	360	380
Test load	(kg)	1125	2250	4500	9000	13500
Load chain specification	(mm)	6×18	7.1×21.2	9×27	9×27	9×27
Net weight	(kg)	5.3	8.6	15.2	23	43
Gross weight	(kg)	5.6	8.9	15.6	23.5	44.5
Packing size	(cm)	31.5*16*12	35*18*13	48*20*13.5	48*21.5*17	53*28*25
Add 1m weight	(kg)	0.7	1.1	1.8	3.6	5.4
Dimensions (mm)	a	115	137	169	238	300
	b	39	44	60	68	91
	c	239	259	374	374	374
	d	28	32	41	47	61
	e	146	162	187	187	187
	f	91	67	98	98	98
Hmin		320	360	431	500	635

VA MANUAL LEVER HOIST

MAKE BY STANDARD: EN13157

- Compact, light yet durable.
- Double-pawli brake system dsigend for safety and rellability.
- Heat treatment steel plates, gears and shafter for enhanced strength: Forged upper lower hooks with forged steel safety latches: High tensile alloy steel chain.
- Free wheeling mechanism for quick chain adjustments
- Weston style automatic load brake with double pawls load raduction.
- 360° rotating handle eases of using in confined space.
- As for the N position of the shift block, the position of the bottom hook can be freely adjusted according to the need when unloaded.
- Salety factor: 4 to 1.
- Fatigue tested at 1.5 times of working load limit to 2000 cycles.

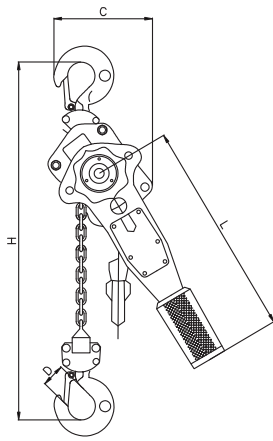

VA 0.25T, 0.5T, 0.75T, 1.5T, 3T

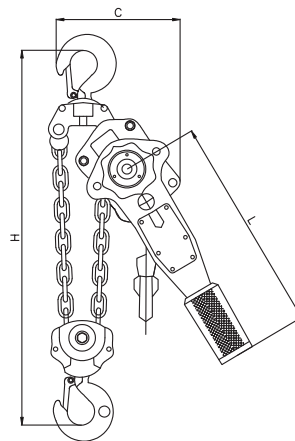
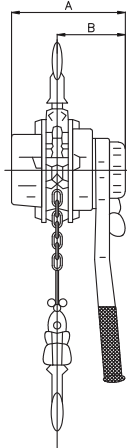

VA 6T

Model		VA-0.75T	VA-1.5T	VA-3T	VA-6T	VA-9T
Capacity load	(t)	0.75	1.5	3	6	9
Standard lift	(m)	1.5	1.5	1.5	1.5	1.5
Test load	(t)	11	22.5	37.5	75	112.5
Effort required to lift max load	(N)	140	220	320	340	360
Laod chain Number of falls		1	1	1	2	3
Load chain specification	(mm)	6	8	10	10	10
Net weight	(kg)	7.5	11.5	21	31.5	47
Gross weight	(kg)	8	12	22	33	49
Packing size	(cm)	35.5*14*16.5	46.5*15.5*19	21*19*21.5	53*22*21.5	82*32*21.5
Add 1m weight	(kg)	0.8	1.4	2.2	4.4	6.6
Dimensions (mm)	A	145	175	203	203	203
	B	86	100	118	118	118
	C	122	130	150	205	316
	D	37	45	50	64	85
	H	320	380	480	620	700
	H	285	370	410	410	410
	K	30	36	40	50	58

DKS SUBSEA CHAIN HOIST

This product is suitable for chemical applications and high cleaning requirements, such as specialist topside and subsea hoisting range, drug processing, food processing, sewage treatment and other industries.

MAKE BY STANDARD: EN13157/ASTM117

- It can be used within an operating temperature range from -40°C to +55°C.
- Chain hoist capacity range from 1 ton to 5 tons.
- Double pawls as standard.
- Stainless steel hook with stainless steel safety latch securely can rotate, freely 360 degrees.
- Stainless steel cover is stronger and more corrosion resistant.
- 600hrs + Protection against salt spray tests according to ASTM B117.
- Calibrated stainless steel load chain, hand chain and bottom hook (stainless steel bottom hooks are only available for 500kg and 1 tonne units).
- Calibrated grade T (8) load chain to BS EN818-7 DT9 corrosion coated and hand chain dacromet corrosion coated.

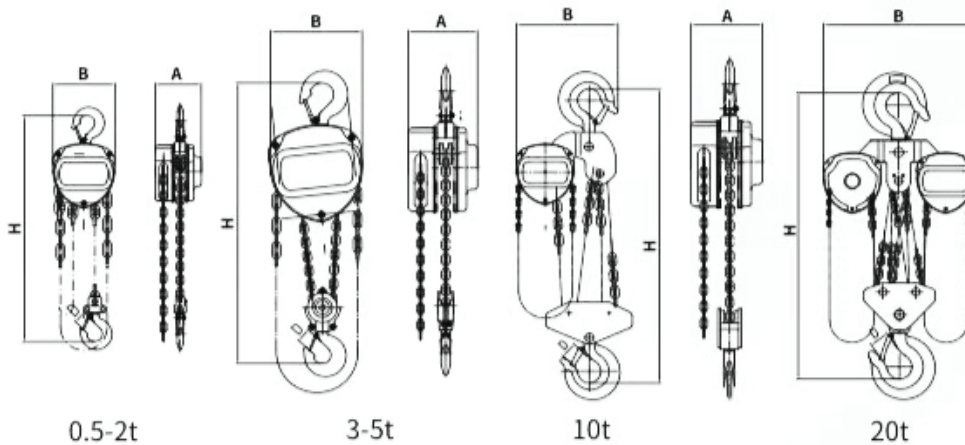

Model		DKS-1T	DKS-2T	DKS-3T	DKS-5T
Capacity load	(t)	1	2	3	5
Test load	(t)	1.5	3	4.5	7.5
Standard lift	(m)	3	3	3	3
Effort required to lift max load	(N)	304	304	343	414
Load chain specification	(mm)	6	6	8	10
Gross weight	(kg)	12	16.5	27	41
Net weight	(kg)	10.5	26	25	39
Packing size	(cm)	25*19*17	31*21*19	34.5*24*19	40*32*19.5
Add 1m weight	(kg)	1.7	2.5	3.7	5.3
Load chain Number of falls		1	2	2	2
Dimensions (mm)	A	126	141	141	163
	B	147	183	183	215
	H	306	368	486	616
	D	32	36	46	46

DF MANUAL CHAIN HOIST

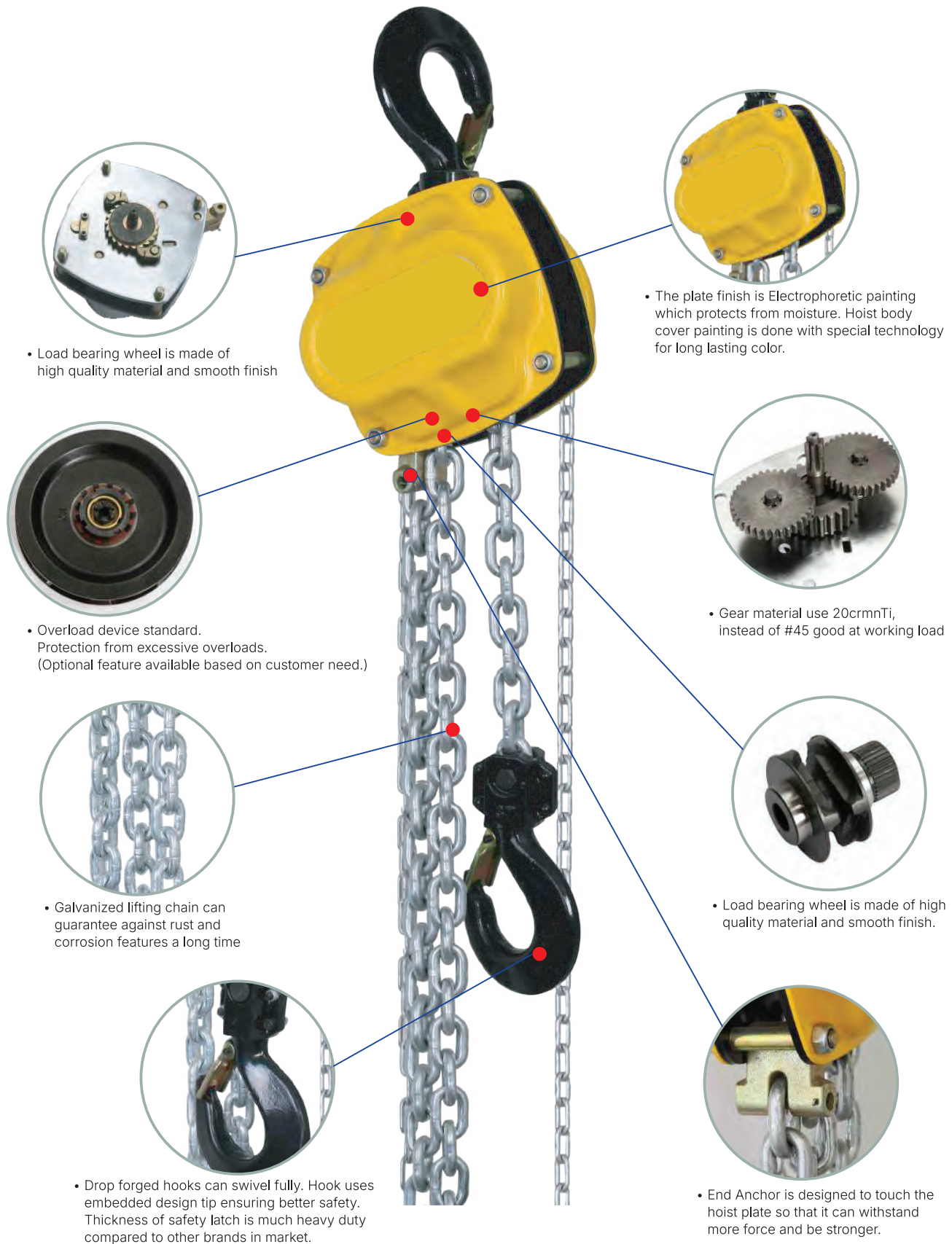

- Load bearing wheel is made of high quality material and smooth finish

- The plate finish is Electrophoretic painting which protects from moisture. Hoist body cover painting is done with special technology for long lasting color.

- Overload device standard. Protection from excessive overloads. (Optional feature available based on customer need.)

- Gear material use 20crmnTi, instead of #45 good at working load

- Galvanized lifting chain can guarantee against rust and corrosion features a long time

- Load bearing wheel is made of high quality material and smooth finish.

- Drop forged hooks can swivel fully. Hook uses embedded design tip ensuring better safety. Thickness of safety latch is much heavy duty compared to other brands in market.

- End Anchor is designed to touch the hoist plate so that it can withstand more force and be stronger.

DF MANUAL CHAIN HOIST

MAKE BY STANDARD: EN13157

- Chain helst capacity range from 0.5 ton to 50 ton
- Compact sized design product suitable for all application
- Suspension and load hooks are made of alloy steel, 35CrMo treated heat and fitted with heavy duty safety latches, fitting groove and inspection points.
- Machined chain sprocket and geses provide smoother, more efficient operation
- Hook with safety latch security can rotate freely 360 degrees
- Ergonomie handle design so that the hoist is easy to operat
- Hoist has an overload protection system.
- Gears are made up of 20CrMnTi material, which ensures toughness and better strength
- Fitted with High strength grade 80 alloy steel load chain with galvanized finish for corrosion resistance (comply with EN 818-74 Safety factor 4)
- Load chain marked with 18 marks as per EN 818-7.
- Heavy duty guide rollers for avoiding slippage of load chain.
- Rugged construction featuring steal gear case and hand wheel cover for hand chain operation
- All hoista tested at 1.5 times of WLL

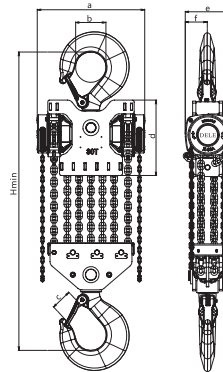

DF 30T

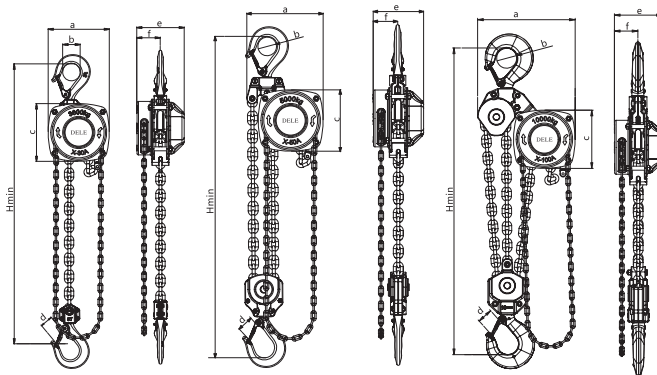

DF 0.5-3T

DF 5T

DF 10T

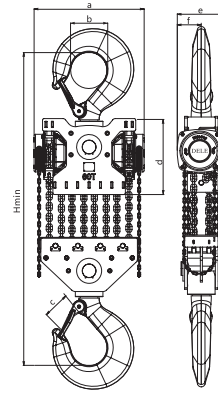

DF 50-60T

Model		DF-0.25 T	DF-0.5 T	DF-1T	DF-1.5T	DF-2T	DF-3T	DF-5T	DF-10T	DF-15T	DF-20T	DF-30T	DF-50T
Capacity load	(t)	0.25	0.5	1	1.5	2	3	5	10	15	20	30	50
Standard lift	(m)	3	3	3	3	3	3	3	3	3	3	3	3
Laod chain Number of falls		1	1	1	1	1	1	2	3	6	8	12	16
Effort required to lift max load	(N)	220	240	305	340	360	370	370	380	360	380	400	400
Test load	(kg)	375	750	1500	2250	3000	4500	7500	15000	22500	30000	45000	75000
Load chain specification	(mm)	4×12	5×15	6×18	8×24	8×24	10×30	10×30	10×30	10×30	10×30	10×30	11.2×31
Hand chain specification	(mm)	3×16.5	5×25	5×25	5×25	5×25	5×25	5×25	5×25	5×25	5×25	5×25	5×25
Net weight	(kg)	4.0	5.7	11	17	17	26	40	73	160	176	258	258
Gross weight	(kg)	4.3	6	11.5	17.6	1706	26.5	40.6	73.6	180	200	285	285
Packing size	(cm)	21×12.2×12.5	27.5×14.5×15.5	28×17×18.5	31×17.5×22	31×17.5×22	39×19×26	44×24×26	58×46.5×24.5	47×42×70	47×42×70	58×44×73	102×60×100
Add 1m load chain weight	(kg)	0.346	0.541	0.77	1.36	1.36	2.2	4.4	6.6	13.2	17.6	26.4	32.4
Add 1m hand chain weight	(kg)	0.4	0.9	0.9	0.9	0.9	0.9	0.9	0.9	1.8	1.8	1.8	1.8
Dimensions (mm)	a	102	122	152	179	176	216	216	244	441	429	533	770
	b	30	35	44	46	49	60	68	91	120	125	150	660
	c	98	118	145	170	170	204	204	204	78	105	105	130
	d	22	22	30	32	34	41	47	61	400	376	373	373
	e	114	119	145	157	157	167	167	167	222	222	220	279
	f	65	65	79	81	81	83	83	83	110	113	109	109
	Hmin	261	311	361	413	413	431	660	705	1098	1100	1139	1625

SLA MANUAL CHAIN HOIST

MAKE BY STANDARD: EN13157

- Chain hoist capacity range from 0,5 ton to 30 ton
- Multi-support structure, more reasonable force, flexible operation and low failure rate of the transmission system
- With double powls, increase the safety factor in 2 times
- All nuts in anti-slip nuts
- Smooth rotation, high efficiency, light hand pull,
- The hand cover uses special crimping process, keep the hand chain not titing and not snapping
- Fitted with high strength grade 80 alloy steel load chain with galvanized finish for corrosion resistance (comply with EN 818-7, safety factor 4)

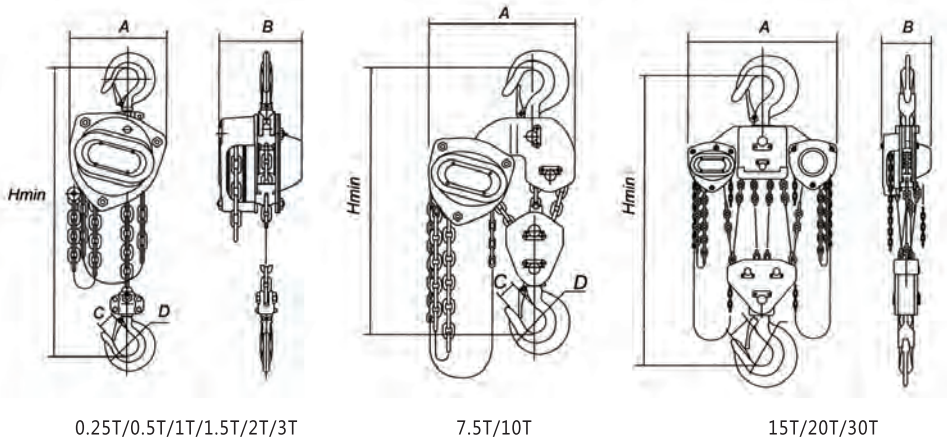

Model		SAL-0.5 T	SAL-1T	SAL-1.5 T	SAL-2T	SAL-3T	SAL-5T	SAL-10T	SAL-15T	SAL-20T	SAL-30 T
Capacity load	(t)	0.5	1	11.5	2	3	5	10	15	20	30
Standard lift	(m)	2.5	2.5	2.5	2.5	3	3	3	3	3	3
Laod chain Number of falls	(mm)	1	1	1	1	1	2	4	6	8	12
Load chain specification	(mm)	2×15	6×18	7×21	8×24	10×30	10×30	10×30	10×30	10×30	10×30
Effort required to lift max load	(N)	240	250	265	335	372	360	380	378	382	395
Gross weight	(kg)	9.8	12.7	17.0	20.0	33.0	42.1	76.7	136.0	194.0	322.0
Net weight	(kg)	9.3	12.2	16.5	19.5	32	41.1	75.7	135	192	320
Packing size	(cm)	30*19*22	30*19*22	35.5*23.5*23	35.5*23.5*23	33.5*27.5*24.5	44*29.5*24.5	-	-	-	-
Dimensions (mm)	A	148	172	196	210	225	280	463	718	840	670
	B	132	151	173	175	205	189	189	200	200	510
	C	23	27	33	35	39	45	54	71	82	81
	D	35	40	45	50	55	65	75	95	106	110
	Hmin	345	367	442	470	548	668	765	900	950	1800

YTG LOW HEADROOM HOIST

MAKE BY STANDARD: EN13157

The YTG Low Headroom hoist is the ideal solution to meet your toughest clearance requirements for special applications. This hoist is custom built to fit long or short reach framing. Using special trolley frame with upper sheave and offset hoist machinery. Lifting heights can be optimized. Allows for maximum hook height in tight clearance applications.

Easy Operation

- Capacity range from 1 ton to 20 ton.
- Ultra-low headroom design for maximum hook travel.
- Extremely low headroom for use where space is limited.
- Efficient hoist drive train minimizes effort required to operate.
- Trolley wheels fit on both tapered and flat flanged beams.
- Maintenance-free sealed trolley ball bearings are lubed life and offer smooth movement with low friction and long life.
- 20' standard lift. Longer lengths available Dependability.

Dependability

- All-steel construction for hoist durability.
- Reliable hoist braking with double enclosed brake cover that keeps out rain, dust and dirt.
- Grade80 heat-treated manganese alloy load chain resists abrasion and wear.
- Cast trolley wheels and steel side plates for heavy-duty applications.

Applications

- Industrial lifting applications where space is limited.
- Demanding environments.

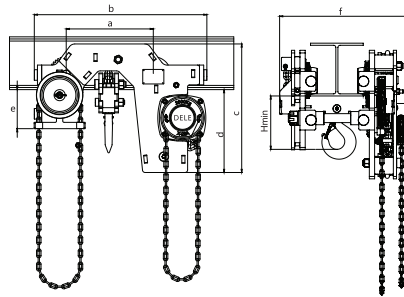

YTG1T - YTG10T

Model		YTG-1T	YTG-2T	YTG-3T	YTG-5T	YTG-10T
Capacity load	(t)	1	2	3	5	10
Standard lift	(m)	3	3	3	3	3
Effort required to lift max load		305	340	350	370	380
Test load	(N)	1250	5200	3750	6250	12500
Load chain specification	(kg)	5×15	6×18	8×24	10×30	10×30
Hand chain specification	(mm)	5×15	5×15	5×15	5×15	5×15
Gross weight	(kg)	41.4	60.1	93.5	134.8	140.91
Net weight	(kg)	34.2	49.6	81.8	118	126.91
Packing size	(cm)	52.2*45*36.3	60.9*48.4*42.3	69.4*52.8*52.7	78.3*58.7*63.2	78.3*58.7*63.2
Add 1m weight	(kg)	1.08	1.54	2.72	4.4	8.8
The Minimum clearance	(mm)	166	192	217	290	303
Beam width (hmin)	(mm)	50-305	47-305	85-305	85-305	85-305
Dimensions (mm)	a	238	280	330	375	480
	b	482	569	654	743	916
	c	323	393	487	592	580
	d	209	249	314	367.5	373
	e	112	134	148	149	181
	f	410	444	488.5	547.5	557.2
	Hmin	148	166	202	239	301

ELECTRIC HOIST WITH HOOK

- **Clutch:** As emergency overload protection, clutch will functions and motor will slip when abnormal load.
- **Inverse phase sequence protecting device:** It is the special electrical installation which controls the circuit not working in case of wiring error in the power supply.
- **Limit switch:** The limit switch device is installed where the weight is lifted on and off to make the motor to stop automatically so as to prohibit the chains from exceeding for safety.
- **Side magnetic braking device:** This device shall realize the instant brake in case of the power dump.
- **Chain:** Japan FECBO chain ultra heat-treatable steel alloy chain. Lifting height is against your requirement.
- **Emergency stop button:** if any emergencies, press it, the motor circuit will be out off. Control voltage: 24V,36V,48V,110V are optional. Low control voltage help to prohibit the emergencies occurring in case of hand switch leakage.
- **wireless remote control, and overheat protector can be assembled.**

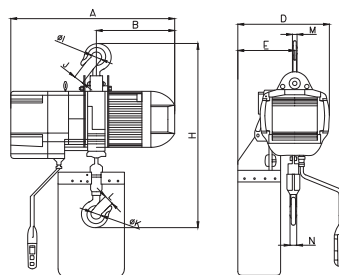

Technical Details

Model	Capacity load (t)	Hoisting height (m)	Hoisting speed (m/min)		Lifting motor					
			Single speed	Single speed & Frequency conversion	Power (Kw)	Single speed (r/min)	Double speed (r/min)	Number of phase	Voltage (V)	Frequency (Hz/s)
DLED-00501	0.5	3	6.8	6.8&1.7	0.75	1440	1440&360	3	200-600	50
DLED-0101	1	3	6.6	6.6&1.65	1.5	1440	1440&360	3	200-600	50
DLED-0102	1	3	3.4	3.4&0.85	0.75	1440	1440&360	3	200-600	50
DLED-01501	1.5	3	8.8	8.8&2.2	3.0	1440	1440&360	3	200-600	50
DLED-0201	2	3	6.6	6.6&1.65	3.0	1440	1440&360	3	200-600	50
DLED-0202	2	3	3.3	3.3&0.82	1.5	1440	1440&360	3	200-600	50
DLED-02501	2.5	3	5.4	5.4&1.35	3.0	1440	1440&360	3	200-600	50
DLED-0301	3	3	5.4	5.4&1.35	3.0	1440	1440&360	3	200-600	50
DLED-0302	3	3	4.4	4.4&1.1	3.0	1440	1440&360	3	200-600	50
DLED-0303	3	3	2.2	2.2&0.55	1.5	1440	1440&360	3	200-600	50
DLED-0502	5	3	2.7	2.7&0.67	3.0	1440	1440&360	3	200-600	50

Size specification table

H	A	B	D	E	I (Single)	I (Double)	J	K (Single)	K (Double)	L	M	N	Diameter x number of Chains
455	566	266	285	165	Φ35	Φ35	27	Φ34	Φ34	25	17	17	Φ6.3x1
520	627	302	300	176	Φ42	Φ42	32	Φ41	Φ41	32	24	24	Φ7.1x1
490	566	266	285	165	Φ42	Φ35	32	Φ41	Φ35	32	24	24	Φ6.3x2
640	733	343	430	265	Φ48	Φ48	38	Φ49	Φ49	40	28	28	Φ10.0x1
640	733	343	430	265	Φ48	Φ48	38	Φ49	Φ49	40	28	28	Φ10.0x1
705	627	302	300	236	Φ48	Φ48	38	Φ49	Φ49	40	28	28	Φ7.1x2
685	733	343	430	265	Φ59	Φ59	48	Φ59	Φ59	48	34	34	Φ11.2x1
685	733	343	430	265	Φ59	Φ59	48	Φ59	Φ59	48	34	34	Φ11.2x1
790	733	343	430	320	Φ59	Φ59	48	Φ59	Φ59	48	34	34	Φ10.0x2
820	627	302	350	205	Φ59	Φ59	48	Φ59	Φ59	48	34	34	Φ7.1x3
870	733	343	430	325	Φ60	Φ59	48	Φ60	Φ60	48	42	42	Φ11.2x2

ELECTRIC TROLLEY

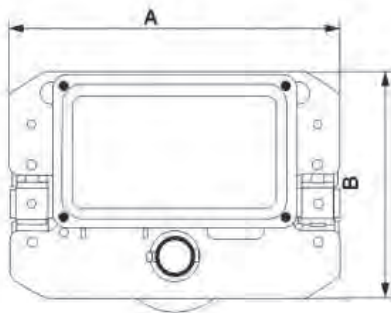
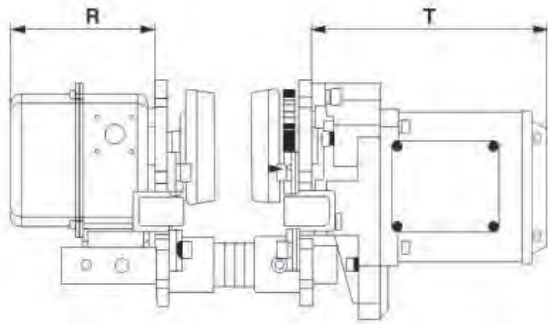

0.5T-10T

Model	Capacity (t)	Unit (mm)				Speed 50 Hz (m/min)	Motor (kw)	Minimum radius of turn (m)	I-Beam (mm)
		A	B	R	T				
DLET-0.5	0.5	315	212	142	231	11&21	0.4	0.8	58-153
DLET-01	1	315	212	142	231	11&21	0.4	0.8	58-153
DLET-02	2	325	220	142	231	11&21	0.4	0.8	82-178
DLET-03	3	340	250	142	231	11&21	0.75	1.0	100-178
DLET-05	5	400	291	142	231	11&21	0.75	1.8	100-178
DLET-7.5	7.5	400	291	142	231	11&21	0.75	1.8	100-178
DLET-10	10	500	370	142	231	11&21	0.75	2.5	150-220

3.2~20TON SINGLE GIRDER WIRE ROPE HOIST

- Trolley with frequency conversion motor
- Double speed/frequency conversion lifting motor
- Motor protection grade IP55, insulation grade F
- Electromagnetic disc brake, maintenance-free
- Control voltage 24V/36V/48V/110V
- Schneider contactor & inverter
- 380V/415V/440V/460V/3PH/50Hz
- Lifting limit switch
- Hook, with safety latch
- Overload limiter
- Ambient temperature: 20°C~+ 40°C
- Motor over temperature protection

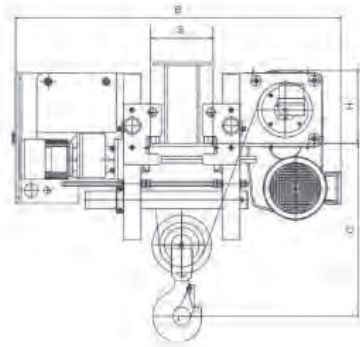
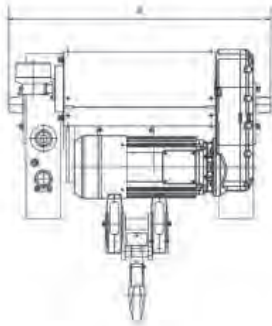

Model	Capacity load (t)	Standard lift (m)	Work Level FEM/ISO	Lifting speed (m/min)	Lifting power (kw)	Travelling speed (m/min)	Travelling power (kw)	Size H (mm)	Size C (mm)	Size A (mm)	Size B (mm)	Size S (mm)
DLER-3.2-6S	3.2	6	2m/M5	5/0.8	3.2/0.45	5-20	0.64	243	556	932	1087~1587	200-500
DLER-3.2-9S	3.2	9	2m/M5	5/0.8	3.2/0.45	5-20	0.64	243	556	1082	1087~1587	200-500
DLER-3.2-12S	3.2	12	2m/M5	5/0.8	3.2/0.45	5-20	0.64	243	556	1282	1087~1587	200-500
DLER-3.2-15S	3.2	15	2m/M5	5/0.8	3.2/0.45	5-20	0.64	243	556	1482	1087~1587	200-500
DLER-3.2-18S	3.2	18	2m/M5	5/0.8	3.2/0.45	5-20	0.64	243	556	1682	1087~1587	200-500
DLER-5.0-6S	5.0	6	2m/M5	5/0.8	6/0.9	5-20	0.64	255	596	940	1095~1395	200-500
DLER-5.0-9S	5.0	9	2m/M5	5/0.8	6/0.9	5-20	0.64	255	596	1090	1095~1395	200-500
DLER-5.0-12S	5.0	12	2m/M5	5/0.8	6/0.9	5-20	0.64	255	596	1290	1095~1395	200-500
DLER-5.0-15S	5.0	15	2m/M5	5/0.8	6/0.9	5-20	0.64	255	596	1490	1095~1395	200-500
DLER-5.0-18S	5.0	18	2m/M5	5/0.8	6/0.9	5-20	0.64	255	750	1690	1095~1395	200-500
DLER-10.0-6S	10.0	6	2m/M5	5/0.8	9.5/1.5	5-20	0.95	315	750	940	1282~1582	200-500
DLER-10.0-9S	10.0	9	2m/M5	5/0.8	9.5/1.5	5-20	0.95	315	750	1090	1282~1583	200-500
DLER-10.0-12S	10.0	12	2m/M5	5/0.8	9.5/1.5	5-20	0.95	315	750	1290	1282~1584	200-500
DLER-10.0-15S	10.0	15	2m/M5	5/0.8	9.5/1.5	5-20	0.95	315	750	1490	1282~1585	200-500
DLER-10.0-18S	10.0	18	2m/M5	5/0.8	9.5/1.5	5-20	0.95	315	750	1690	1282~1586	200-500
DLER-12.5-6S	12.5	6	1AM/M4	5/0.8	12.5/2	5-20	0.95	315	750	940	1282~1587	200-500
DLER-12.5-9S	12.5	9	1AM/M4	5/0.8	12.5/2	5-20	0.95	315	750	1090	1282~1588	200-500
DLER-12.5-12S	12.5	12	1AM/M4	5/0.8	12.5/2	5-20	0.95	315	750	1290	1282~1589	200-500
DLER-12.5-15S	12.5	15	1AM/M4	5/0.8	12.5/2	5-20	0.95	315	750	1490	1282~1590	200-500
DLER-12.5-18S	12.5	18	1AM/M4	5/0.8	12.5/2	5-20	0.95	346	900	1690	1282~1591	200-500
DLER-16.0-6S	16.0	6	2m/M5	4/0.7	16/2.6	5-20	0.95×2	346	900	1690	1282~1591	200-500
DLER-16.0-9S	16.0	9	2m/M5	4/0.7	16/2.6	5-20	0.95×2	346	900	1690	1282~1591	200-500
DLER-16.0-12S	16.0	12	2m/M5	4/0.7	16/2.6	5-20	0.95×2	346	900	1690	1282~1591	200-500
DLER-16.0-15S	16.0	15	2m/M5	4/0.7	16/2.6	5-20	0.95×2	346	900	1690	1282~1591	200-500
DLER-16.0-18S	16.0	18	2m/M5	4/0.7	16/2.6	5-20	0.95×2	346	900	1690	1282~1591	200-500
DLER-20.0-6S	20.0	6	1AM/M4	4/0.7	16/2.6	5-20	0.95×2	346	900	1690	1282~1591	200-500
DLER-20.0-9S	20.0	9	1AM/M4	4/0.7	16/2.6	5-20	0.95×2	346	900	1690	1282~1591	200-500
DLER-20.0-12S	20.0	12	1AM/M4	4/0.7	16/2.6	5-20	0.95×2	346	900	1690	1282~1591	200-500
DLER-20.0-15S	20.0	15	1AM/M4	4/0.7	16/2.6	5-20	0.95×2	346	900	1690	1282~1591	200-500
DLER-20.0-20S	20.0	18	1AM/M4	4/0.7	16/2.6	5-20	0.95×2	346	900	1690	1282~1591	200-500

LIFTING CLAMP

DLD UNIVERSAL LIFTING CLAMP

- Articulated lifting shackle.
- Clamps are equipped with a safety mechanism, ensuring the clamp does not slip when lifting force is applied and when load is being lowered.
- The clamp is locked in closed as well as in open position.
- Manufactured from high quality carbon steel.

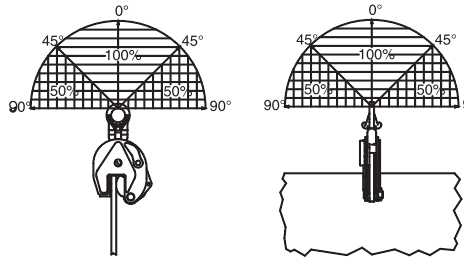

Model	WLL (t) per pair	Jaw Opening(mm)	Net Weight (kg)
DLD-0.8	0.8	0-15	2.0
DLD-1	1.0	0-20	5.0
DLD-2	2.0	0-25	7.3
DLD-3	3.0	0-30	15.0
DLD-5	5.0	0-50	23.0
DLD-8A	8.0	0-45	37.0
DLD-8B	8.0	40-80	
DLD-12	12.0	50-100	59.5

DPH PIPE LIFTING CLAMP

- For horizontal lifting and transporting of steel and concrete pipes.
- Compact shape and relatively low own weight with a high lifting capacity.
- The surface is equipped with "special" plastic.
- The DPH will be delivered per pair.
- Plastic cover is easy to change.

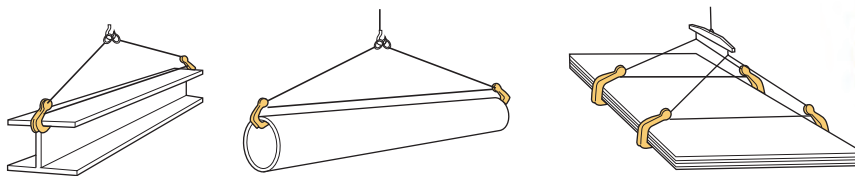

Model	WLL (t) per pair	Jaw Opening (mm)	Dimensions (mm)						Net Weight (kg)
			A (mm)	B (mm)	C (mm)	D (mm)	E (mm)	T (mm)	
5	1.5	40	122	30	195	70	39	Φ25	2.2
6.5	3.0	40	122	30	195	70	39	Φ25	2.6
8	4.0	50	122	30	215	70	39	Φ28	2.9
10	6.0	50	122	30	215	70	39	Φ28	3.5
13	8.0	70	126	30	240	70	39	Φ28	3.8
16	12.0	70	160	30	260	90	45	Φ36	6.7
19	16.0	70	168	30	272	90	50	Φ37	9.4
22	18.0	70	183	30	292	90	50	Φ37	13
26	20.0	70	220	30	333	90	50	Φ45	19.3

LIFTING CLAMP

DPD HORIZONTAL LIFTING CLAMP

- Suitable for lifting and transport of steel plates, construction and profiled bar in horizontal position.
- Manufactured from high quality carbon steel.
- Avoid snatch or shock loading.
- The working load limit is the maximum load that the clamp is authorized support when used in pairs with a lift angle of 60°. in lifting operations the clamps can be used in pairs or multiples.
- The screw jaw of the body can be changed, also have a safety button.

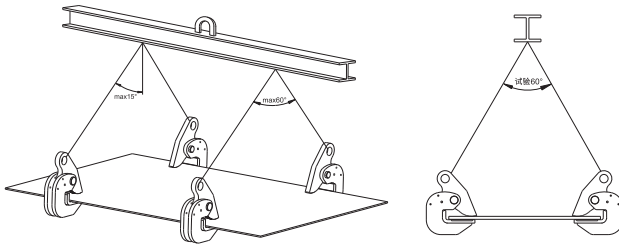

Model	WLL(t) per pair	Jaw opening (mm)	Net weight (kg)
DPD-0.8	0.8	0-25	2.5
DPD-1	1.0	0-30	3.5
DPD-1.6	1.6	0-30	4.0
DPD-2	2.0	0-40	5.0
DPD-3	3.0	0-45	6.0
DPD-4	4.0	0-50	6.5
DPD-5	5.0	0-55	7.5
DPD-6	6.0	0-65	10.0
DPD-8	8.0	0-100	22.0
DPD-10	10.0	0-125	33.0

DVC VERTICAL LIFTING CLAMP

- Standard design clamp for vertical lifting of steel plates and steel structures.
- The spring-loaded tightening lock mechanism assures a positive initial clamping force
- Clamps are equipped with a safety mechanism, ensuring the clamp does not slip when lifting force is applied and when load is being lowered.
- The clamp is locked in being closed as well as in open position.
- Manufactured from high quality carbon steel.
- High-frequency quenching of die-forged special alloy steels gives greater durability to the cam.

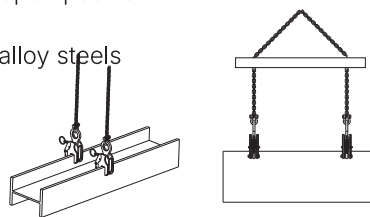

Model	WLL(t) per pair	Jaw opening (mm)	Net weight (kg)
DVC-0.8	0.8	0-16	2.8
DVC-1	1.0	0-22	3.6
DVC-2	2.0	0-30	5.5
DVC-3	3.0	0-40	10
DVC-5	5.0	0-50	17
DVC-8	8.0	0-60	26
DVC-10	10.0	0-90	32

LIFTING CLAMP

DLC HORIZONTAL LIFTING CLAMP

- Working load limit (WLL) 1-3 ton.
- Clamp for the horizontal lifting of "H", "T", "T", "L" shaped structured steel.
- From a mechanics point of view, these clamps have ideal designs, which are compact, light weight, easy to use.
- The main body and parts are made from die-forged special alloy steels, which are optimally tempered for maximum strength and durability

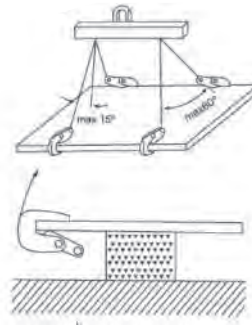

Model	WLL(t) per pair	Jaw opening (mm)	Net weight (kg)
DLC-1	1.0	1-13	2.1
DLC-2	2.0	3-22	4.7
DLC-3	3.0	12-35	8.0

BEAM CLAMP

MAKE BY STANDARD: EN13157

Universal beam clamp has been designed not only for vertical use, but also for side load applications, where conventional clamps are not suitable.

- The Universal beam clamp is suitable for pulling and lifting at angles across the beam or as a semi-permanent anchor point.
- It can be loaded at any angle and eliminates the use of spreader beams in various lifting operations.
- Fitted with an adjustable locking mechanism, ensuring secure clamping to the beam.
- Built-in suspension point for low headroom design.
- Light weight design allowing for quick clamping and unclamping.

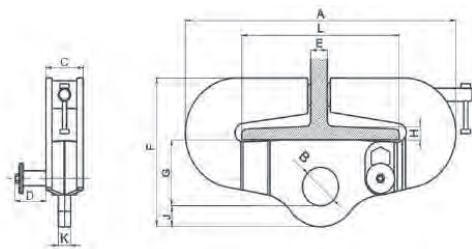

Model	WLL (t)	A (mm)	B (mm)	C (mm)	D (mm)	E (mm)	F (mm)	G (mm)	H (mm)	J (mm)	K (mm)	L (mm)	Net Weight (kg)
DLBC-2	2	375	58	70	57	32	217	93	25	23	16	125-204	10.6
DLBC-3	3	387	60	70	57	32	235	100	25	28	20	125-204	12.50
DLBC-5	5	527	70	74	60	32	270	120	25	38	24	125-305	20.50
DLBC-10	10	527	70	74	60	32	278	120	25	38	24	125-305	24.50

DYC LIFTING CLAMP/DML SERIES PERMANENT MAGNETIC LIFTER

DYC BEAM CLAMP

For lifting equipment provides a quick and general assembly, slide or carrying purposes due to its wide range of regulatory, making its application very flexible, center screw axis allowed to increase accessory device and safety handle, the center axis of safe and reliable to prevent loosening.

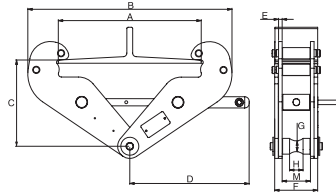

DYC 1-10T



Model		DYC-1000A	DYC-2000A	DYC-3000A	DYC-5000A	DYC-10000A
Rated capacity	(t)	1	2	3	5	10
Width of steel beam	(mm)	75-230	75-230	80-320	90-230	90.320
Net weight	(kg)	3.85	5	9	11	18
Gross weight	(kg)	4	5.2	9.2	11.4	18.4
Packing Size	(cm)	30.6*7.7*24	30.6*8.8*24	38.5*11.2*32.7	38.5*14.4*32.7	38.5*13.8*41
Dimensions (mm)	A	75-230	75-230	80-320	90-320	90.320
	B	180-375	180-375	220-498	220-498	250-514
	C	80	90	117	127	139
	D	220	220	271	271	271
	E	4	6	8	10	12
	F	61.6	73.6	95.6	107.6	115.6
	G	17	20	24	27	36
	H	25	25	30	35	40
	M	45	49	63	67	67

DML SERIES PERMANENT MAGNETIC LIFTER

Features:

- DML Model safety factor 3.5:1
- Strong permanent magnetic circuit
- Stable and lasting working performance
- High safety factor and reliable quality

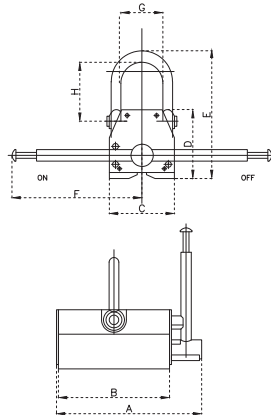

Model	Rated Capacity (mm)	Pull-off force	Length (mm)	Width (mm)	Height (mm)	Net Weight (kg)	Gross Weight (kg)
DML-01T	100	3.5	87	64	69	3.5	4
DML-0.2T	200	3.5	142	87	85	7.6	8.1
DML-0.3T	300	3.5	178	88	85	9.6	11
DML-0.4T	400	3.5	200	112	103	16	17
DML-0.6T	600	3.5	222	111	116	20.1	22
DML-0.8T	800	3.5	267	133	123	30	32
DML-1T	1000	3.5	295	143	143	41	43
DML-1.5T	1500	3.5	355	155	155	61	65
DML-2T	2000	3.3	360	160	182	71	77
DML-3T	3000	3.3	467	160	182	95	99
DML-5T	5000	3.3	600	232	260	222	230
DML-10T	10000	3.0	600	467	260	580	600

DSL IRON WIRE ROPE PULLEY MACHINE

DYC BEAM CLAMP



Model		DLHS-0.8T	DLHS-1.6T	DLHS-3.2T
Rated capacity	(t)	0.8	1.6	3.2
Pulling Capacity	(t)	1.2	2.4	4
Lever Pull at Rated Load	(N)	284	412	441
Forward Travel	(mm)	≥52	≥55	≥28
Wire Rope Diameter	(mm)	8.3	11	16
Net Weight(Body)	(kg)	6.8	12.8	23.4
Net Weight (20m Wire Rope)	(kg)	6.5	10.5	22
Net Weight (Lever Handle)	(kg)	1.3	2.3	2.3
Dimensions (Body) L*W*H	(mm)	440*70*255	560*100*295	675*120*350
Chassis	Cold rolled steel sheet made of stamping high strength			
Shell Surface Treatment	Spray. Chrome plated standard for sandgray, color can be customized			
Jaw Block	Using 40 cr, suitable hardness after quenching that does not damage the wire rope and ensure safety			
Wire Rope	Hot dip galvanized, structure 6×19W+IWR, the standard 20 mtr. strength 170Mpa, length can be customized			
Wire Rope Hook	Standard American eye hook, material 35CrMo, high tensile strength. Swivel hook or European hook can be used as required			

DSL ALUMINIUM WIRE ROPE PULLEY MACHINE

Advantages of the wire rope pulley machine

- Simple structure and powerful function
Fast and easy installation, simple to feed in or remove the wire rope, continuous operation without snatching, change over from forward to reverse operation by transferring the operating handle from one lever to another, works in any position horizontal, vertical or angled.
- The length of the wire rope is not limited
Standard length of steel wire rope is 20 meters but custom length are available on request.
- Safe and reliable
Each winch is tested to 1.5 times of the rated capacity. The jaws and connecting axle have been quenched, and the modules have been electroplated. The performance of the products will not be affected after the four-fold.



DSL-TW800

Model	Rated Capacity	Lever Pull at Rated Load	Forward Travel	Wire Rope Diameter	Safety Factor	Pulling Capacity	Net Weight (Body)	Net Weight (20m Wire Rope)	Net Weight (Lever Handle)
DSL-TW800	800kg	332N	≥52mm	8.3mm	5	1200kg	6.4kg	7kg	1.2kg
Max overall Size(mm)	A	B	C	D	E	F	G		
	44	60	101	420	430	172	240		

DSL ALUMINUM WIRE ROPE POLLEY MACHINE

- Chassis** High strength 104 aluminum alloy
- Shell Surface Treatment** Spray, standard for sand gray, color can be customized
- Jaw Blocks** Using 40Cr, suitable hardness after quenching that does not damage the wire rope and can ensure safety
- Wire Rope** Hot dip galvanized, structure 6×19W+IWR-8.3MM, the standard 20 meters, strength 1770Mpa, length can be customized
- Wire Rope Hook** Standard American eye hook, material 35CrMo, high tensile strength. Swivel hook or European hook can be used as required

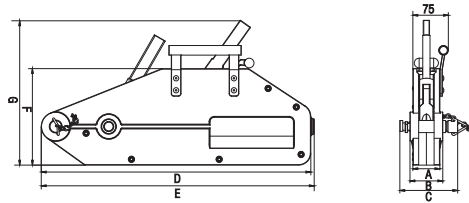

1.6T

DSL-TW1600

Model	Rated Capacity	Lever Pull at Rated Load	Forward Travel	Wire Rope Diameter	Safety Factor	Pulling Capacity	Net Weight (Body)	Net Weight (20m Wire Rope)	Net Weight (Lever Handle)
DSL-TW1600	1600kg	445N	≥55mm	11mm	5	2400kg	12.4kg	11.5kg	2.5kg
Max overall	A	B	C	D	E	F	G		
Size(mm)	56	68	120	545	556	200	270		

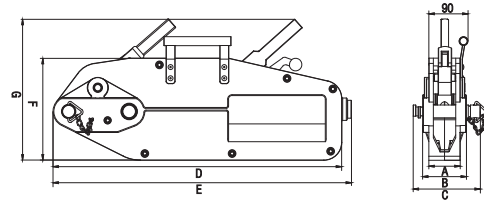

3.2T

DSL-TW3200

Model	Rated Capacity	Lever Pull at Rated Load	Forward Travel	Wire Rope Diameter	Safety Factor	Pulling Capacity	Net Weight (Body)	Net Weight (20m Wire Rope)	Net Weight (Lever Handle)
DSL-TW3200	3200kg	441N	≥28mm	16mm	5	4800kg	21.2kg	22.5kg	2.5kg
Max overall	A	B	C	D	E	F	G		
Size(mm)	70	98	150	645	666	227	320		

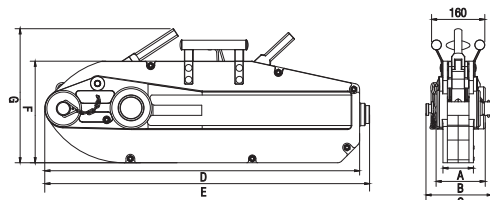

5.4T

DSL-TW5400

Model	Rated Capacity	Lever Pull at Rated Load	Forward Travel	Wire Rope Diameter	Safety Factor	Pulling Capacity	Net Weight (Body)	Net Weight (20m Wire Rope)	Net Weight (Lever Handle)
DSL-TW5400	5400kg	745N	≥30mm	20mm	5	8000kg	58kg	32.6kg	3.7kg
Max overall	A	B	C	D	E	F	G		
Size(mm)	90	160	200	935	940	300	410		

DTK ROLLER SKATE/DME HYDRAULIC BOTTLE JACK

DTK ROLLER SKATE

- Suitable for moving and transport heavy objects, machine and equipments
- Manufacturing from high quality carbon steel
- Duration oiled metal wheels with polyurethane cover
- Avoid snatch or shock loading
- Must be used in pairs for moving
- The load can be lifted using either the roller crowbar or jack, allowing the skates to be easily positioned
- The skates are maintained free and fitted with handles for easing of carrying and positioning



DTKO



DTKA

Model	W.L.L (t)	Number of Wheels (pcs)	Net Weight (kg)	Gross Weight (kg)	Packing Size (cm)
DTKO-4	6	4	12	13	31*22*10
DTKA-4	6	4	13.5	14.5	31*22*13
DTKO-6	8	6	17.8	18.8	41*22*10
DTKA-6	8	6	19.2	20.5	41*22*13
DTKO-8	12	8	23.6	25.7	51*22*10
DTKA-8	12	8	25	27	51*22*13
DTKO-12	18	12	34.5	36.7	51*31*11
DTKA-12	18	12	37.1	39.5	51*31*14



DME HYDRAULIC BOTTLE JACK

Model	Rated Capacity (t)	Min. H (mm)	Lifting H (mm)	Adjust H (mm)	Max. H (mm)	Net Weight (kg)	Package	Packing Size (cm)	Qty/Ctn (pcs)	Gross Wtg. (kg)	20 Conatiner (pcs)
DME-0203	2	158	90	60	308	2.23	Color Box	52*25.5*19	10	23	7800
DME-0303	3-4	159	125	60	380	3.2	Color Box	46*26.5*22.5	8	26	5400
DME-0503	5-6	197	125	60	382	4.1	Color Box	38*27.5*22.5	6	25	4200
DME-0803	8	205	125	60	390	4.9	Color Box	29.5*27.5*22.5	4	20	3340
DME-1003	10	205	125	60	390	5.6	Color Box	30.15*29.5*24	4	23	3000
DME-1203	12	215	125	60	400	6.5	Color Box	30.15*29.5*24	2	13.5	2500
DME-1503	15-16	225	140	60	425	7.8	Color Box	31.5*17*24.5	2	16	2250
DME-2003	20	244	145	60	449	10.2	Color Box	34.5*19.5*27	2	21	1500
DME-3203A	30-32	285	180	/	465	13.5	Color Box	37.5*19*31	2	28	1240
DME-3203	32	285	180	/	465	14	Color Box	37.5*19*31	2	28.5	1240
DME-5003	50	300	180	/	480	29.5	Carbon	26*24*33	1	30	540
DME-0203S	2	158	90	60	308	2.23	Blow Case	34.5*34.5*25.5	6	16	4800
DME-0303S	3-4	195	125	60	380	3.2	Blow Case	38.5*35.5*29.5	6	23	4200
DME-0503S	5-6	197	125	60	382	4.1	Blow Case	39.5*26.5*30.5	4	20	3500
DME-0803S	8	205	125	60	390	4.9	Blow Case	39.5*26.5*30.5	4	24	3500
DME-1003S	10	205	125	60	390	5.6	Blow Case	31*22.5*32.5	2	14	1280
DME-1203S	12	215	125	60	400	6.5	Blow Case	31*22.5*32.5	2	16	1280

DLSYC-A MANUAL STACKER

DLSYC-A MANUAL STACKER

- It applies C type steel structure design, lifting more stable and safe
- All manual stackers have been equipped with wheel frame protection device
- The handle have been surrounded with rubber, with lengthing design. Using more comfortable
- Single frame have two ways to unload by manual and pedal, using more flexible
- Fork with adjustable nut, it can easy to adjust the fork height
- Wheel frame equipped with grease fitting design, it will help do routine maintenance for bearing
- There are too many kinds of fork types, fixed fork, adjusting fork, also with the adjusting wide leg or fixed wide leg



SINGLE FRAME SERIES

Model	Unit	DLSYC0516-A	DLSYC1016-A	DLSYC1516-A	DLSYC2016-A
Power Supply		Manual	Manual	Manual	Manual
Unload Type		Hand	Hand	Hand	Hand
Rated Capacity	kg	500	1000	1500	2000
Max. Lifting Height	mm	1600	1600	1600	1600
Lowered Fork Height	mm	85	85	85	85
Fork Length	mm	1000	1150	1150	1150
Fork Height	mm	330-740	330-740/550	330-740/550	330-740/550
Front Wheel	mm	φ80*58	φ80*58	φ80*58	φ80*58
Loaded Wheel	mm	φ180*50	φ180*50	φ180*50	φ180*50
Overall Dimension	mm	1600*760*2030	1600*760*2030	1600*760*2030	1600*760*2030
Leg Width	mm	590	690	690	690
Net Weight	kg	150	224	240	270

DOUBLE FRAME SERIES

Model	Unit	DLSYC1020/1520/2020-A	DLSYC1025/1525-A	DLSYC1030/1530-A
Power Supply		Manual	Manual	Manual
Unload Type		Hand	Hand	Hand
Rated Capacity	kg	1000/1500/2000	1000/1500	1000/1500
Max. Lifting Height	mm	2000	2500	3000
Lowered Fork Height	mm	85	85	85
Fork Length	mm	1150	1150	1150
Fork Height	mm	330-740	330-740	330-740
Front Wheel	mm	φ80*58	φ80*58	φ80*58
Loaded Wheel	mm	φ180*50	φ180*50	φ180*50
Overall Dimension	mm	1600*760*1580	1600*760*1840	1600*760*2080
Leg Width	mm	690	690	690
Net Weight	kg	290	310	330

SEMI-ELECTRIC STACKER

SEMI-ELECTRIC STACKER

Performance characteristics

- Beautiful outline, streamline contour make it extraordinary and outstanding
- High quality steel ensures that pallet truck has stable and remarkable strength
- Mechanical brake mechanism can safely stop pallet truck under any circumstances
- High-power motor will shortened hoisting time, and improve the working efficiency, when overload the stacker will automatically slow and steady placed the pallet
- Steering wheel protection and safety hood make your operation to be more trust worthy
- Higher strength structural design



SINGLE FRAME SERIES

Model	Unit	DLSPN1016	DLSPN1516	DLSPN2016
Rated Capacity	kg	1000	1500	2000
Load Center	mm	400	400	400
Max. Lifting Height	mm	1600	1600	1600
Max. Machine Height	mm	2030	2030	2030
Fork Size	mm		1150*160	
Fork Width	mm		adjusting width (365-670) fixed width (550)	
Outer Width & Front Leg	mm		620/490	
Battery	V/Kw		12/1.5-1.6	
Aneroid Battery	V/Ah		12/120	
Charger	V/A		12/15	
Overall Length	mm		1875	
Overall Width	mm	810	810	810
Overall Height	mm	2030	2030	2030
Overall Net Weight	kg	370	385	410

DOUBLE FRAME SERIES

Model	Unit	DLSPN1020/1520	DLSPN1025/1525	DLSPN1030/1530	DLSPN1030/1530	DLSPN2020
Rated Capacity	kg	1000-1500	1000-1500	1000/1500	1000/1500	2000
Load Center	mm	400	400	400	400	400
Max. Lifting Height	mm	2000	2500	3000	3500	2000
Max. Machine Height	mm	2560	3060	3560	4060	2560
Fork Size	mm			1150*160		
Fork Width	mm			adjusting width (365-670) fixed width (550)		
Outer Width & Front Leg	mm			620/490		
Battery	V/Kw			12/1.5-1.6		
Aneroid Battery	V/Ah			12/120		
Charger	V/A			12/15		
Overall Length	mm	1875	1875	1875	1875	1875
Overall Width	mm	810	810	810	810	810
Overall Height	mm	1570	1820	2070	2310	1570
Overall Net Weight	kg	445	470	495	520	490

HAND PALLET TRUCK



Nylon wheel
Welding pump

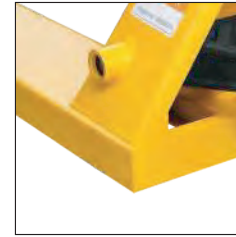

PU wheel
Casting pump

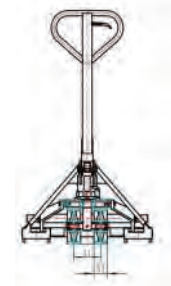
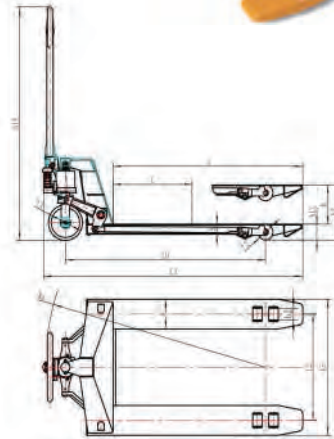
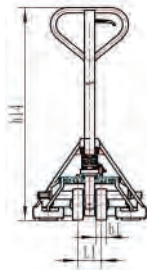
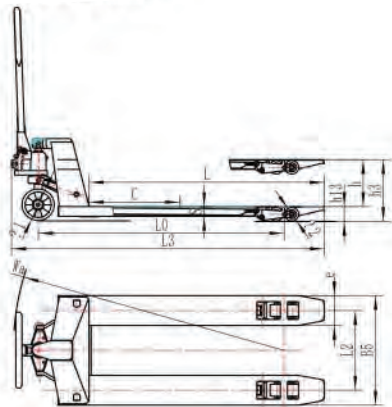

DLT HAND PALLET TRUCK

Manufacturer	Unit	Heami Machinery	
Model		DLT	
Drive		Manual	
Load capacity	Q kg	2000/2500	
Load centre distance	C mm	478	536
Wheelbase	L0 mm	1202	1252
Net weight	kg	50-60	
Steer wheel	mm	Ø160*50	
Load wheel	mm	Ø70*60	
Wheels, number steer/load		2/4	
Tread width, steer	L1 mm	128	
Tread width, load	L2 mm	400	535
Lift	h mm	110	
Height of tiller in drive position	h14 mm	1072	
Height raised	h3 mm	185	
Height lowered	h13 mm	75	
Overall length	L3 mm	1529	1579
Width across forks	b5 mm	550	685
Fork dimensions	s/e/l mm	47/150/1150	47/150/1200
Turning radius	Wa mm	1322	1372

DNBJ HAND PALLET TRUCK

Manufacturer	Unit	Heami Machinery	
Model		DNBJ	
Drive		Manual	
Load capacity	Q kg	2500/3000	
Load centre distance	C mm	494	529
Wheelbase	L0 mm	1239	1309
Net weight	kg	75-85	
Steer wheel	mm	Ø160*50 or Ø160*70	
Load wheel	mm	Ø63*76 or Ø63*100	
Wheels, number steer/load		2/4 or 2/2	
Tread width, steer	L1 mm	128	
Tread width, load	L2 mm	400	535
Lift	h mm	115	
Height of tiller in drive position	h14 mm	1155	
Height raised	h3 mm	178	
Height lowered	h13 mm	68	
Overall length	L3 mm	1516	1586
Width across forks	b5 mm	550	685
Fork dimensions	s/e/l mm	49/150/1150	49/150/1220
Turning radius	Wa mm	1345	1414

MANUAL TROLLEY

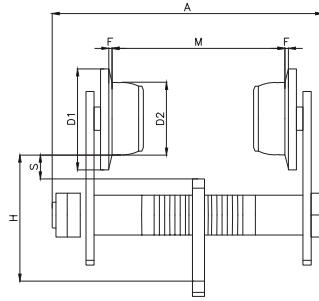
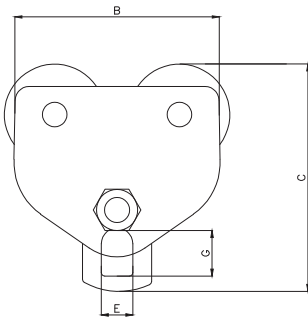

DTP TYPE PLAIN TROLLEY

Model	Rated capacity (t)	Min. Curve Radlue (m)	Beam Flange Width(mm)		Dimensions(mm)											Net Weight(kg)	
					M		A		B	C	D1	D2	F	E	G		
			a	b	a	b											
DTP0.5	0.5	0.8	68-140	82-203	220	285	192	175	Φ88	Φ57	1.5-3	23	37	95	25	4.8	5.1
DTP1	1.0	0.9	80-146	64-203	230	295	213	191	Φ84	Φ60	1.5-3	24	38	107	21	7	7.4
DTP2	2.0	1.0	80-168	68-203	275	310	255	233	Φ102	Φ75	1.5-3	29	45	128	29	13	13.3
DTP3	3.0	1.2	88-168	102-203	285	325	320	282	Φ120	Φ90	1.5-3	36	65	153	22	20.2	20.5
DTP5	5.0	1.3	114-203		335		380	343	Φ141	Φ110	1.5-3	45	75	216	31	34	
DTP10	10.0	1.6	125-203		375		454	477	Φ189	Φ150	1.5-3	70	110	262	32	79	

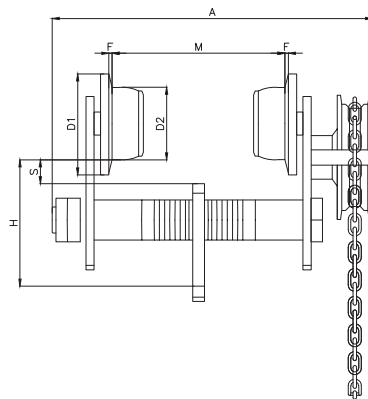
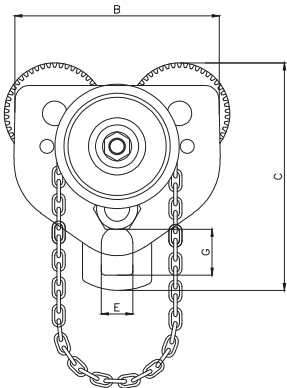

DTG TYPE GEARED TROLLEY

Model	Rated capacity (t)	Min. Curve Radlue (m)	Beam Flange Width(mm)		Dimensions(mm)											Net Weight(kg)	
					M		A		B	C	D1	D2	F	E	G		
			a	b	a	b											
DTG0.5	0.5	0.8	68-140	82-203	262	317	192	175	Φ88	Φ57	1.5-3	23	37	95	25	8.4	8.7
DTG1	1.0	0.9	80-146	64-203	266	327	213	191	Φ84	Φ60	1.5-3	24	38	107	21	10.8	11.5
DTG2	2.0	1.0	80-168	68-203	312	351	255	233	Φ102	Φ75	1.5-3	29	45	128	29	16	17
DTG3	3.0	1.2	88-168	102-203	324	364	320	282	Φ120	Φ90	1.5-3	36	65	153	22	23.5	24.8
DTG5	5.0	1.3	114-203		358		380	343	Φ141	Φ110	1.5-3	45	75	216	31	37.5	
DTG10	10.0	1.7	125-203		412		454	477	Φ189	Φ150	1.5-3	70	110	262	32	92	
DTG20	20.0	3.5	125-203		453		550	567	Φ225	Φ168	1.5-3	76	115	315	40	180.3	
DTG30	30.0	6	125-203		463		630	645	Φ255	Φ196	1.5-3	90	130	354	39	252	

MANUAL TROLLEY

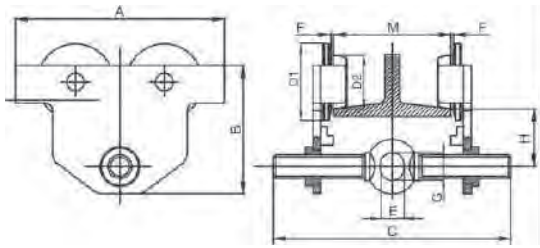

DAP TYPE PLAIN TROLLEY

Model	Rated capacity (t)	Min. Curve Radlue (m)	Beam Flange Width(mm) M	Dimensions(mm)								Net Weight(kg)	
				A	B	C	D1	D2	F	E	G		H
DAP0.5	0.5	0.8	64-220	200	150	292	Φ78	Φ57	1.5-3	25	30	65	5.9
DAP1	1.0	0.9	64-220	240	163	300	Φ96	Φ67	1.5-3	30	35	75	9.3
DAP2	2.0	1.0	88-220	286	190	310	Φ109.6	Φ80	1.5-3	40	47	80	15.3
DAP3	3.0	1.2	102-220	320	225	320	Φ129.3	Φ92	1.5-3	48	58	95	24.7
DAP5	5.0	1.3	114-220	370	255	335	Φ143	Φ109	1.5-3	60	75	105	39

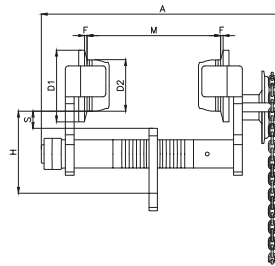
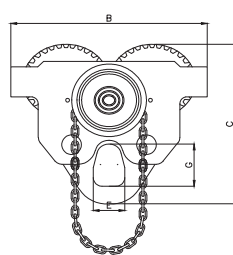

DTDG TYPE GEARED TROLLEY

Model	Rated capacity (t)	Min. Curve Radlue (m)	Beam Flange Width(mm) M	Dimensions(mm)										Net Weight(kg)
				A	B	C	D1	D2	F	E	G	H	S	
DTDG0.5	0.5	0.8	68-126	250	196	174	Φ78	Φ57	1.5-3	24	38	97	22	8.2
DTDG1	1.0	0.9	80-146	260	213	174	Φ84	Φ60	1.5-3	24	38	89	27	10.8
DTDG2	2.0	1.0	80-150	299	255	216	Φ102	Φ75	1.5-3	37	52	111	33	16.6
DTDG3	3.0	1.2	80-150	312	300	249	Φ120	Φ90	1.5-3	42	59	117	30	24.5
DTDG5	5.0	1.3	100-203	378	340	305	Φ141	Φ110	1.5-3	46	75	154	43	39.6
DTDG10	10.0	1.6	122-203	418	450	410	Φ189	Φ150	1.5-3	72	110	195	45	81

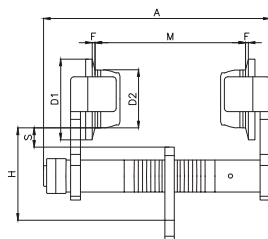
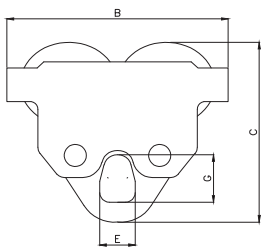

DTDP TYPE PLAIN TROLLEY

Model	Rated capacity (t)	Min. Curve Radlue (m)	Beam Flange Width(mm) M	Dimensions(mm)								Net Weight(kg)		
				A	B	C	D1	D2	F	E	G		H	S
DTDP0.5	0.5	0.8	68-126	210	196	174	Φ78	Φ57	1.5-3	24	38	97	22	5.5
DTDP1	1.0	0.9	80-146	230	213	174	Φ84	Φ60	1.5-3	24	38	89	27	7.6
DTDP2	2.0	1.0	80-150	234	255	216	Φ102	Φ75	1.5-3	37	52	111	33	10
DTDP3	3.0	1.2	80-150	248	300	249	Φ120	Φ90	1.5-3	42	59	117	30	21
DTDP5	5.0	1.3	100-203	314	340	305	Φ141	Φ110	1.5-3	46	75	154	43	36.2
DTDP10	10.0	1.6	122-203	344	450	410	Φ189	Φ150	1.5-3	72	110	195	45	77.6



G1000 COMPONENTS

G100 INTEGRATED SHORTENING HOOK

- Material: forged super alloy steel
- 100% tested at 2.5 times working load limit
- 100% magnaflux crack detection
- Sampling break test for each lot
- Fatigue tested at 1.5 times working load limit for 20000 cycles
- Pine are 100% eddy-current test flew detection
- Suitable for G100 chain

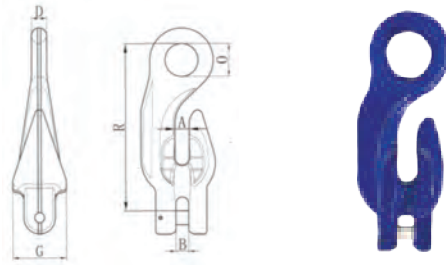

SIZE (mm)	Dimensions (mm)						W.L.L. (T)	Weight (kg)
	A	B	D	G	O	R		
6	8.5	7.2	9.4	28.2	18.2	83.4	1.4	0.27
8	11.2	9.5	12.6	40	24.2	121.2	2.5	0.74
10	13.5	12	14.5	47.8	31	157.4	4	1.49
13	16.8	15.8	20	61.9	36.5	201.0	6.7	3.27
16	20.2	18.6	24	80	48.2	233.6	10	5.0
20	24.5	24.5	28	108.2	58	279.1	16	8.88

G100 INTEGRATED SHORTENING HOOK ASSEMBLY WITH MASTER LINK 1-LEG

- Material: Forged super alloy steel
- 100% tested at 2.5 times working load limit
- 100% magnaflux crack detection
- Sampling break test for each lot
- Fatigue tested at 1.5 mes working load limit for 20000 cycles
- Pinn are 100% eddy-current testat flaw detaction
- Suitable for G100 chain

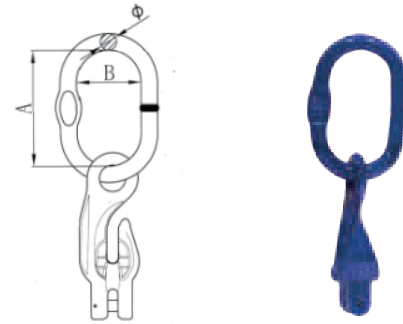

Size (mm)	Dimensions (mm)			W.L.L. (T)	Weight (kg)
	A	B	Φ		
6	110	60	13	1.4T	0.64
8	110	60	16	2.5T	1.27
10	135	75	18	4.0T	2.64
13	160	90	22	6.7T	4.75
16	180	100	26	10T	7.93

G100 INTEGRATED SHORTENING HOOK ASSEMBLY WITH MASTER LINK 2-LEG

- Mstrial Forged super alloy steel
- 100% tested at 2.5 times working load limit
- 100% magnaflux crack detection
- Sampling break test for each lot
- Fatigue tested at 1.5 times working load limit for 20000 cycles
- Pins are 100% eddy-current test flew detection
- Suitable for G100 chain

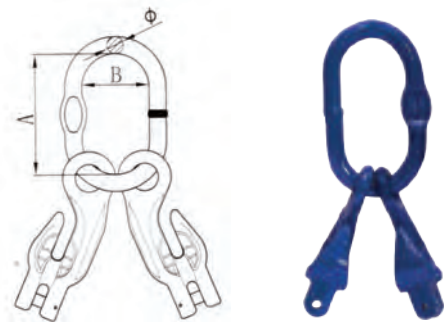

SIZE (mm)	DIMENSIONS (mm)			W.L.L. (T)	Weight (kg)
	A	B	Φ		
6	110	60	13	20	0.94
8	135	75	18	3.5	2.50
10	160	90	22	5.6	4.47
13	180	100	26	9.4	8.90
16	200	110	33	14.0	12.93

G100 INTEGRATED SHORTENING HOOK ASSEMBLY WITH MASTER LINK 4-LEG

- Material Forged super alloy steel
- 100% tested at 2.5 times Working Load Limit
- 100% magnaflux crack detection
- Sampling break test for each lot
- Fatigue tested at 1.5 times Working Load Limit for 20000 cycles
- Pins are 100% eddy-current test flaw detection
- Suitable for G100 chain

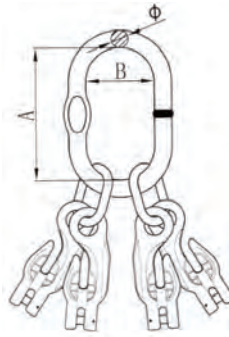

SIZE (mm)	DIMENSIONS (mm)			W.L.L. (T)	Weight (kg)
	A	B	Φ		
6	135	75	20	2.9	2.54
8	160	90	22	5.3	5.23
10	180	100	27	8.4	9.82
13	200	110	32	14.1	19.21
16	260	140	36	21	29.97

G100 MASTER LINK

- Material: Forged super alloy steel
- Suitable for G100 chain
- 100% tested at 2.5 times working load limit
- 100% magnaflux crack detection
- Sampling break test for each lot
- Ultimate Load is 4 times the Working Load Limit
- All sizes: There will be pressing flat only on request

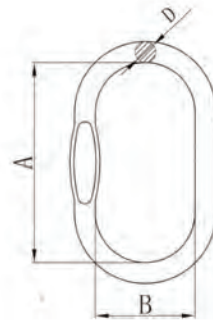

DIMENSIONS (mm)		DIMENSIONS (mm)			W. L. L (T)	Weight (kg)
FOR 1 LEG (mm)	FOR 2 LEG (mm)	A	B	D		
6+7	9	110	60	13	2.3	0.34
8	7	110	60	16	3.5	0.53
10	8	135	75	18	5	0.86
13	10	160	90	22	7.6	1.47
16	13	180	100	26	10	2.31
19	16	200	110	32	14	3.95
22	19	260	140	36	25.1	6.33
26	22	340	180	45	30.8	12.81
32	26	350	190	50	40	16.54

G100 MASTER LINK ASSEMBLY

- Material: Forged super alloy steel
- Suitable for G100 chain
- 100% tested at 2.5 times working load limit
- 100% magnaflux crack detection
- Sampling break test for each lot
- Ultimate Load is 4 times the working load limit
- The pressing flat for use with G100 OMEGA LINK (Stock No GQOMH)
- There will be pressing flat only on request

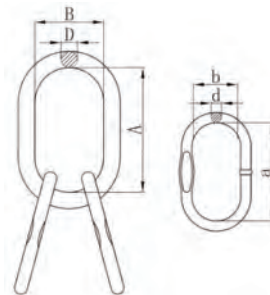

G100 CHAIN (mm)	DIMENSIONS (mm)						W. L. L. (T)	Weight (kg)
FOR 3/4 LEGS SLING (mm)	A	B	D	a	b	d		
6	135	5	20	54	25	13	3	1.4
8	160	90	22	70	35	16	5.3	2.23
10	180	100	26	85	40	20	8.4	3.70
13	200	110	32	115	50	22	14	6.12
16	260	140	36	140	65	26	21.2	9.86
19/20	350	190	50	150	70	32	33.6	23.2
22	350	190	50	170	75	36	39.9	26.0
26	400	200	60	180	80	45	55.7	41.7
32	460	250	72	200	110	50	84	66.7

G100 CONNECTING LINK

- Material: Forged super alloy steel
- 100% tested at 2.5 times working load limit
- 100% magnaflux crack detection
- Sampling break test for each lot
- Fatigue tested at 1.5 times working load limit for 20000 cycles
- Pinn are 100% eddy-current teat flaw detection
- Suitable for G100 chain

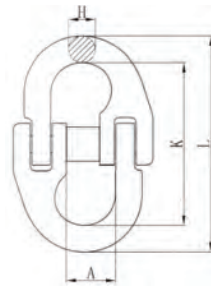

SIZE (mm)	DIMENSIONS (mm)				W.L.L. (T)	Weight (kg)
	H	A	K	L		
6	7.2	15.2	46.4	60.8	1.4	0.08
8	9.6	19.0	62.4	82.0	2.5	0.18
10	12.5	23.0	68.6	94.6	4	0.34
13	15.8	30.6	90.4	122.4	6.7	0.68
16	19.8	36.1	101.6	141.4	10	1.34
20	24.0	43.3	121.4	171.5	16	2.05

G100 CONNECTING LINK

- Material: Forged super alloy steel
- 100% tested at 2.5 times working load limit
- 100% magnaflux crack detection
- Sampling break test for each lot
- Fatigue tested at 1.5 times working load limit for 20000 cycles
- Pinn are 100% eddy-current teat flaw detection
- Suitable for G100 chain

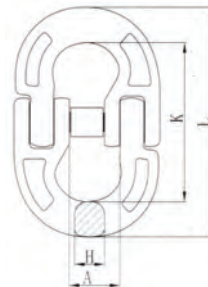

SIZE (mm)	DIMENSIONS (mm)				W.L.L. (T)	Weight (kg)
	L	K	A	H		
6	59.6	43.7	14.1	7.3	1.4	0.08
7	73.3	53.3	19.0	8.5	2	0.15
8	85.6	62.4	19.4	9.8	2.5	0.22
10	101.2	71.2	24.0	12.5	4	0.41
13	128.0	89.0	27.9	16.4	6.7	0.89
16	159.8	113.0	34.0	19.8	10	1.82
20	189.5	125.8	44.6	24.0	16	3.10
22	228.0	155.2	52.0	25.5	19	4.86
26	258.2	178.0	61.6	30.2	26.5	7.16
32	299.4	207.4	80.4	36.8	40	11.90

G100 EYE SELF LOCKING HOOK

- Material: Forged super alloy steel
- 100% tested at 2.5 times working load limit
- 100% magnaflux crack detection
- Sampling break test for each lot
- Fatigue tested at 1.5 times working load limit for 20000 cycles
- Pinn are 100% eddy-current teat flaw detection
- Suitable for G100 chain



SIZE (mm)	DIMENSIONS (mm)				W.L.L. (T)	Weight (kg)
	B	L	R	r		
6	22.0	28.3	109.5	16.5	1.4	0.50
7/8	25.9	33.2	136.9	21.0	2.5	0.86
10	32.0	43.1	165.7	24.5	4	1.52
13	40.0	51.5	208.0	33.6	6.7	3.15
16	56.0	61.6	252.7	41.3	10	5.72
20	62.6	84.0	268.8	47.8	16	8.10
22	70.0	77.4	312.3	47.4	19	11.70

G100 EYE SELF LOCKING HOOK WITH HIDDEN TRIGGER

- Material: Forged super alloy steel
- 100% tested at 2.5 times working load limit
- 100% magnaflux crack detection
- Sampling break test for each lot
- Fatigue tested at 1.5 times working load limit for 20000 cycles
- Pinn are 100% eddy-current test flaw detection
- Suitable for G100 chain

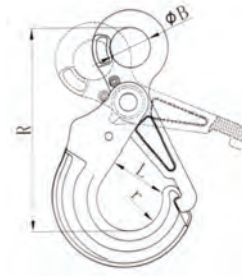

SIZE (mm)	DIMENSIONS (mm)				W.L.L. (T)	Weight (kg)
	R	B	r	L		
7/8	137.3	27	22.1	38.0	2.5	0.78
10	166.5	34	29.0	47.0	4	1.4
13	203.0	40	31.3	50.9	6.7	2.6
16	247.7	50	39.2	68.0	10	4.6

G100 CLEVIS SELF LOCKING HOOK

- Material: Forged super alloy steel
- 100% tested at 2.5 times working load limit
- 100% magnaflux crack detection
- Sampling break test for each lot
- Fatigue tested at 1.5 times working load limit for 20000 cycles
- Pinn are 100% eddy-current test flaw detection
- Suitable for G100 chain

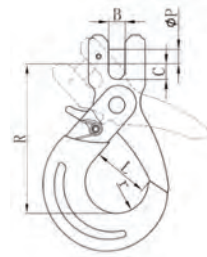

SIZE (mm)	DIMENSIONS (mm)						W.L.L. (T)	Weight (kg)
	B	C	L	P	R	r		
6	9.2	7.4	28.3	7.8	96.2	16.5	1.4	0.49
8	9.5	8.8	33.2	10.3	119.5	21.0	2.5	0.89
10	12.8	15.0	43.1	13.0	142.3	27.5	4	1.48
13	15.0	18.0	51.5	16.5	185.1	33.6	6.7	3.20
16	19.0	20.5	61.6	20.0	217.5	41.3	10	6.01
20	25.4	26.0	84.0	24.0	228.2	47.8	16	8.38
22	24.5	26.0	77.4	28.0	269.9	47.4	19	11.88

G100 CLEVIS SELF LOCKING HOOK WITH HIDDEN TRIGGER

- Material: Forged super alloy steel
- 100% tested at 2.5 times working load limit
- 100% magnaflux crack detection
- Sampling break test for each lot
- Fatigue tested at 1.5 times working load limit for 20000 cycles
- Pinn are 100% eddy-current test flaw detection
- Suitable for G100 chain

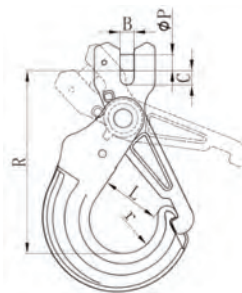

SIZE (mm)	DIMENSIONS (mm)						W.L.L. (T)	Weight (kg)
	B	ΦP	C	R	L	r		
8	9.2	10.3	9.3	117.7	38.0	22.1	2.5	0.8
10	12.4	13.0	12.0	147.7	47.0	29.0	4	1.5
13	15.2	16.5	14.5	174.5	50.9	31.3	6.7	2.68
16	18.8	20.0	22.6	206.3	68.0	39.2	10	4.48

G100 SWIVEL SELF LOCKING HOOK WITH BEARING

- Material: Forged super alloy steel
- 100% tested at 2.5 times working load limit
- 100% magnaflux crack detection
- Sampling break test for each lot
- Fatigue tested at 1.5 times working load limit for 20000 cycles
- Suitable for G100 chain

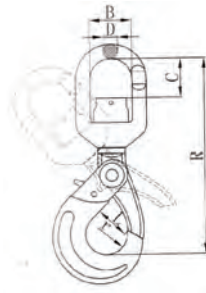

SIZE (mm)	DIMENSIONS (mm)						W.L.L. (T)	Weight (kg)
	L	R	r	B	C	D		
6	28.3	151.6	16.5	32.0	33.3	10.9	1.4	0.75
7/8	33.2	189.7	21.0	37.0	40.5	14.0	2.5	1.24
10	43.1	230.0	27.5	48.0	47.7	18.0	4	2.35
13	51.5	285.8	33.6	57.5	60.2	20.8	6.7	4.27
16	61.6	334.0	41.3	73.0	66.2	24.9	10	8.25
20	84.0	356.5	47.8	71.0	63.0	26.0	16	11.20
22	77.4	450.0	47.4	96.0	90.5	33.0	19	18.08

G100 SWIVEL SELF LOCKING HOOK WITH BUSHING

- Material: Forged super alloy steel
- 100% tested at 2.5 times working load limit
- 100% magnaflux crack detection
- Sampling break test for each lot
- Fatigue tested at 1.5 times working load limit for 20000 cycles
- Suitable for G100 chain

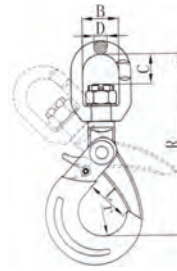

SIZE (mm)	DIMENSIONS (mm)						W.L.L. (T)	Weight (kg)
	L	R	r	B	C	D		
6	28.3	148.8	16.5	32.5	24.4	11.3	1.4	0.75
7/8	33.2	181.8	21.0	35.0	26.9	12.7	2.5	1.17
10	43.1	216.3	27.5	42.0	33.2	15.5	4	2.00
13	51.5	268.8	33.6	49.0	42.0	16.5	6.7	3.80
16	61.6	324.5	41.3	61.0	57.0	22.5	10	7.80
20	84.0	356.5	47.8	71.0	59.5	26.0	16	10.55
22	77.4	453.9	47.4	96.0	94.4	33.0	19	17.60

G100 SWIVEL SELF LOCKING HOOK WITH BEARING WITH HIDDEN TRIGGER

- Material: Forged super alloy steel
- 100% tested at 2.5 times working load limit
- 100% magnaflux crack detection
- Sampling break test for each lot
- Fatigue tested at 1.5 times working load limit for 20000 cycles
- Suitable for G100 chain

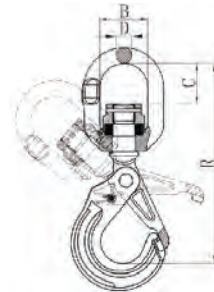

SIZE (mm)	DIMENSIONS (mm)				W.L.L. (T)	Weight (kg)
	R	C	B	D		
7/8	205.0	45.0	53.0	16.5	2.5	1.88
10	257.0	59.0	61.0	22.5	4	2.64
13	302.0	63.5	71.0	26.0	6.7	6.06
16	354.5	71.5	85.0	28.0	10	9.41

G100 SWIVEL SELF LOCKING HOOK WITH BUSHING WITH HIDDEN TRIGGER

- Material: Forged super alloy steel
- 100% tested at 2.5 times working load limit
- 100% magnaflux crack detection
- Sampling break test for each lot
- Fatigue tested at 1.5 times working load limit for 20000 cycles
- Suitable for G100 chain

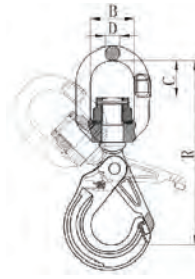

SIZE (mm)	DIMENSIONS (mm)				W.L.L. (T)	Weight (kg)
	R	C	B	D		
7/8	205.0	45.0	53.0	16.5	2.5	1.88
10	257.0	59.0	61.0	22.5	4	2.64
13	302.0	63.5	71.0	26.0	6.7	6.06
16	354.5	71.5	85.0	28.0	10	9.41

G100 CLEVIS SLING HOOK WITH LATCH

- Material: Forged super alloy steel
- 100% tested at 2.5 times working load limit
- 100% magnaflux crack detection
- Sampling break test for each lot
- Fatigue tested at 1.5 times working load limit for 20000 cycles
- Pinn are 100% eddy-current test flaw detection
- Suitable for G100 chain

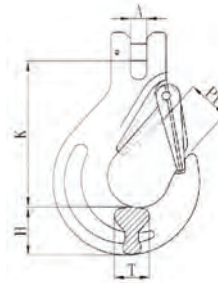

SIZE (mm)	DIMENSIONS (mm)					W.L.L. (T)	Weight (kg)
	K	P ₁	A	T	H		
6	69.6	19.0	7.5	15	21.0	1.4	0.29
8	93.3	24.0	9.5	19	29.0	2.5	0.59
10	108.7	31.5	12.0	26	34.0	4	1.25
13	134.2	39.5	15.8	32	42.0	6.7	2.38
16	156.0	44.5	18.5	38	47.5	10	3.55
20	183.5	52.0	24.0	51	51.5	16	6.90
22	210.0	60.0	26.0	50	61.5	19	9.00
26	238.0	70.0	30.0	69.5	79.5	26.5	17.20
32	297.0	85.0	36.0	83.5	97.0	40	33.50

G100 EYE SLING HOOK WITH LATCH

- Material: Forged super alloy steel
- 100% tested at 2.5 times working load limit
- 100% magnaflux crack detection
- Sampling break test for each lot
- Fatigue tested at 1.5 times working load limit for 20000 cycles
- Suitable for G100 chain



SIZE (mm)	DIMENSIONS (mm)						W.L.L. (T)	Weight (kg)
	K	P ₁	A	D	T	H		
6	85.0	19.0	20	10.5	15.0	21.0	1.4	0.31
7/8	104.5	24.0	25	11.8	19.0	28.8	2.5	0.61
10	129.0	31.5	34	17	26.0	35.0	4	1.25
13	166.0	39.5	43	19	34.0	42.0	6.7	2.32
16	183.5	44.5	50	26	38.5	49.0	10	3.59
20	205.0	52.0	55	28	51.0	51.5	16	6.10
22	226.5	60.0	60	30	50.0	61.5	19	7.92
26	259.7	71.0	70	38	64.5	79.5	26.5	14.17
32	305.5	90.0	66.5	46	83.5	97.0	40	29.00

G100 CLEVIS SHORTENING GRAB HOOK

- Material: Forged super alloy steel
- 100% tested at 2.5 times working load limit
- 100% magnaflux crack detection
- Sampling break test for each lot
- Fatigue tested at 1.5 times working load limit for 20000 cycles
- Pin are 100% eddy-current test flaw detection
- Suitable for G100 chain

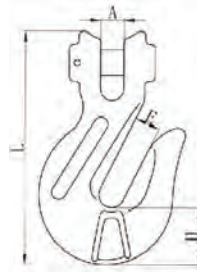

SIZE (mm)	DIMENSIONS (mm)				W.L.L. (T)	Weight (kg)
	A	E	H	L		
6	8	8	20	84.7	1.4	0.26
8	9.5	10.2	24	95.0	2.5	0.42
10	12	13	29	126.5	4	0.84
13	15.5	17	38	155.0	6.7	1.69
16	19.5	20	50	198.0	10	3.35

G100 EYE SHORTENING GRAB HOOK

- Material: Forged super alloy steel
- 100% tested at 2.5 times working load limit
- 100% magnaflux crack detection
- Sampling break test for each lot
- Fatigue tested at 1.5 times working load limit for 20000 cycles
- Suitable for G100 chain

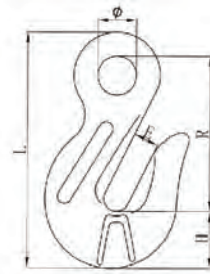

SIZE (mm)	DIMENSIONS (mm)					W.L.L. (T)	Weight (kg)
	Φ	E	H	L	R		
6	13	8	20	82	54	1.4	0.23
8	16	10.2	24	94	60	2.5	0.36
10	20	13	29	127.5	85	4	0.73
13	26	17	38	158	104	6.7	1.57
16	30	20	50	198	129	10	2.95

G100 CLEVIS SHORTENING GRAB HOOK

- Material: forged super alloy steel
- 100% tested at 2.5 times working load limit
- 100% magnaflux crack detection
- Sampling break test for each lot
- Fatigue tested at 1.5 times working load limit for 20000 cycles
- Pin are 100% eddy current test flaw detections
- Suitable for G100 chains

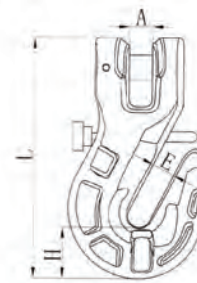

Size (mm)	DIMENSIONS (mm)				W. L. L. (T)	Weight (kg)
	L	H	A	E		
8	11.0	21.0	9.6	9.74	2.5	0.39
10	125.0	26.0	12.1	12.2	4	0.80
13	155.0	34.0	15.6	15.6	6.7	1.64
16	189.0	42.5	18.1	19.1	10.0	3.40
20	240.0	58.5	24.0	26.8	16.0	7.12
22	266.5	64.0	26.0	27.2	19.0	9.10
26	316.0	77.5	30.0	30.8	26.5	14.90
32	388.0	95.5	36.0	37.6	40.0	25.00

G100 EYE SHORTENING GRAB HOOK

- Material: forged super alloy steel
- 100% tested at 2.5 times working load limit
- 100% magnaflux crack detection
- Sampling break test for each lot
- Fatigue tested at 1.5 times working load limit for 20,000 cycles
- Suitable for G100 chains

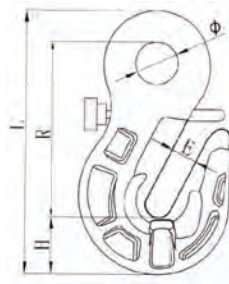

Size (mm)	DIMENSIONS (mm)					W. L. L. (T)	Weight (kg)
	L	R	H	Φ	E		
8	98.0	65.0	21.0	15.8	9.7	2.5	0.38
10	118.5	78.5	26.0	21.4	12.2	4.0	0.73
13	153.5	100.3	34.5	26.0	15.6	6.7	1.60
16	186.5	121.0	42.5	32.3	19.1	10.0	2.88
20	237.5	151.5	58.5	36.5	26.3	16.0	6.30
22	265.0	170.0	64.0	42.5	28.3	19.0	8.50
26	315.5	201.5	77.5	51.0	30.8	26.5	14.20
32	382.5	244.0	96.0	61.0	37.6	40.0	24.20

G100 CLEVIS GRAB HOOK

- Material: forged super alloy steel
- 100% tested at 2.5 times working load limit
- 100% magnaflux crack detection
- Sampling break test for each lot
- Ultimate load is 4 times working load limit
- Fatigue tested at 1.5 times working load limit for 20000 cycles
- Pin are 100% eddy current test flaw detections
- Suitable for G100 chains

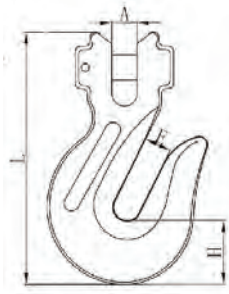

Size (mm)	DIMENSIONS (mm)				W. L. L. (T)	Weight (kg)
	A	E	H	L		
8	9.5	10.2	24	95	2.5	0.40
10	12	13	29	126.5	4	0.79
13	15.5	17	38	155	6.7	1.64
16	19.5	20	50	197.5	10	5.64

G100 CLEVIS CHAIN CLUTCH WITH SHELF PIN

- Material: forged super alloy steel
- 100% tested at 2.5 times working load limit
- 100% magnaflux crack detection
- Sampling break test for each lot
- Fatigue tested at 1.5 times working load limit for 20,000 cycles
- Pin are 100% eddy current test flaw detections
- Suitable for G100 chains

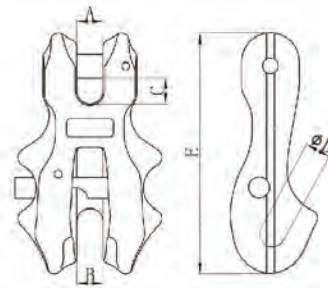

Size (mm)	DIMENSIONS (mm)					W. L. L. (T)	Weight (kg)
	A	B	C	D	E		
6	7.7	7	8.7	7.0	82.0	1.4	0.28
8	10	10	9.2	10.0	91.5	2.5	0.40
10	12	12	12.0	12.0	115	4	0.90
13	15	15	15.8	16.0	160	6.7	2.2
16	21	18	19.0	18.6	190	10	4.0

G100 LARGE OPENING EYE HOOK

- Material: forged super alloy steel
- 100% magnaflux crack detection
- Sampling break test for each lot
- 100% tasted at 2.5 times working load limit
- Fatigue tested at 1.5 times working load limit for 20000 cycles
- Suitable for G100 chains

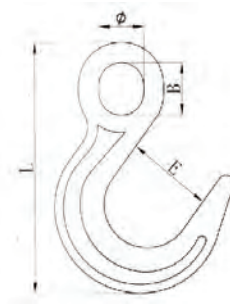

Size (mm)	DIMENSIONS (mm)				W. L. L. (T)	Weight (kg)
	B	E	L	Φ		
6	15.5	53.6	140	15.5	1.4	0.63
7/8	27.8	60.5	158	23.8	2.5	0.78
10	36	76.9	197.5	31	4	1.3
13	44	85.2	245	40	6.7	2.68
16	53	94	288	49	10	4.9
20	65	106	329	61	16	6.81

G100 CLEVIS LARGE OPENING HOOK

- Material: forged super alloy steel
- 100% magnaflux crack detection
- Sampling break test for each lot
- 100% tasted at 2.5 times working load limit
- Pins are 100% eddy current test flaw detection
- Ultimate load is 4 times Working load limit
- Fatigue tested at 1.5 times working load limit for 20000 cycles

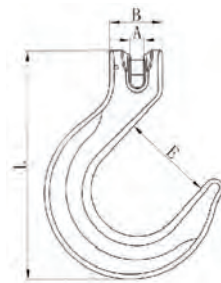

Size (mm)	DIMENSIONS (mm)				W. L. L. (T)	Weight (kg)
	A	B	E	L		
6	8.5	32.5	53.3	140	1.4	0.66
7/8	9.5	37	64.4	159.5	2.5	0.95
10	12	49	77.3	203	4	1.95
13	15.8	56.5	91	245	6.7	3.38
16	18.5	71.5	102.8	285.7	10	5.64



G80 COMPONENTS

G80 CONNECTING LINK

- Material Forged super alloy steel
- 100% tested 2.5 times working load limit
- 100% magnaflux crack detection
- Sampling break test for each lot
- Fatigue tested at 1.5 times working load limit for 20000 cycles
- Pins are 100% eddy-current test faw detection
- Suitable for EN818-2 G80 chain

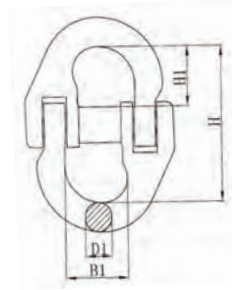

SIZE (mm)	DIMENSIONS (mm)				W.L.L (T)	WEIGHT (kg)
	B1	D1	H1	H		
6	15.2	7.2	20.7	46.4	1. 1/2	0.09
7	19.2	8.5	26.7	59.4	1.5	0.15
8	19.0	9.6	28.0	62.6	2	0.19
10	25.0	11.8	30.9	69.8	3.15	0.33
13	30.6	15.8	40.2	90.4	5.3	0.70
16	36.1	19.8	44.9	101.7	8	1.22
18	40.5	21.0	47.8	110.6	10	1.47
20	42.1	22.7	52.0	119.0	12.5	1.95
22	49.1	24.5	67.7	152.4	15	3.08
26	58.5	31.5	71.2	162.4	12.2	5.10
32	67.5	38.5	84.7	194.0	31.5	9.34
38	87.0	47.0	107.5	246.0	45.3	18.23

G80 CONNECTING LINK

- Material Forged super alloy steel
- 100% tested 2.5 times working load limit
- 100% magnaflux crack detection
- Sampling break test for each lot
- Fatigue tested at 1.5 times working load limit for 20000 cycles
- Pins are 100% eddy-current test faw detection
- Suitable for EN818-2 G80 chain

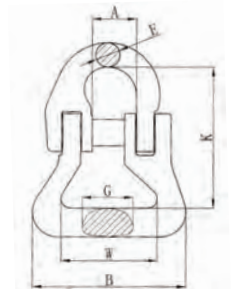

SIZE (mm)	DIMENSIONS (mm)						W.L.L (T)	WEIGHT (kg)
	A	B	K	W	G	E		
6	15.2	60.0	56.5	40.0	18.6	7.2	1.12	0.20
7/8	19.2	69.6	65.8	45.6	22.8	8.5	2	0.32
10	25.0	90.7	75.9	56.1	28.9	11.8	3.15	0.64
13	30.6	104.4	96.6	65.4	34.5	15.8	5.3	1.17
16	36.1	131.1	115.4	80.2	42.0	19.8	8.0	2.30
20	42.0	129.0	138.0	80.0	51.8	24.5	12.5	3.30

G80 CLEVIS CHAIN CLUTCH

- Material Forged super alloy steel
- 100% tested 2.5 times working load limit
- 100% magnaflux crack detection
- Sampling break test for each lot
- Fatigue tested at 1.5 times working load limit for 20000 cycles
- Pins are 100% eddy-current test faw detection
- Suitable for EN818-2 G80 chain

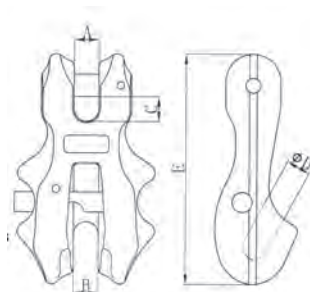

SIZE (mm)	DIMENSIONS					W.L.L (T)	WEIGHT (kg)
	A	B	C	D	E		
6	7.7	7	8.8	7	82.0	1.12	0.28
7/8	10	10	9.3	9.8	91.9	2	0.40
10	12	12	12.1	12.1	115	3.15	0.90
13	15	15	15.9	15.8	160	5.3	2.2
16	21	18	19.1	18.6	190	8	4.0

G80 CLEVIS CHAIN CLUTCH

- Material Forged super alloy steel
- 100% tested 2.5 times working load limit
- 100% magnaflux crack detection
- Sampling break test for each lot
- Fatigue tested at 1.5 times working load limit for 20000 cycles
- Pins are 100% eddy-current test faw detection
- Suitable for EN818-2 G80 chain



SIZE (mm)	DIMENSIONS (mm)					W.L.L (T)	WEIGHT (kg)
	A	B	C	E	L		
6	7.7	7.7	33.4	30.9	72.6	1.12	0.17
7/8	9.5	9.5	45.0	36.0	100.4	2	0.40
10	13.0	13.0	55.0	48.0	137.0	3.15	1.0
13	16.0	16.0	75.0	59.0	177.0	5.3	1.91
16	21.0	21.0	91.0	73.0	218.0	8	3.72
20	23.0	23.0	100.0	80.0	235.0	12.5	4.62
22	25.5	25.5	118.0	98.0	294.0	15	8.50
26	30.0	30.0	144.0	110.0	362.0	21.2	15.8

Ultimate load is 4 times working load limit, proof load is 2.5 times working load limit.

G80 OMEGA RING

- Material Forged super alloy steel
- 100% tested 2.5 times working load limit
- 100% magnaflux crack detection
- Sampling break test for each lot
- Fatigue tested at 1.5 times working load limit for 20000 cycles
- Pins are 100% eddy-current test faw detection
- Suitable for EN818-2 G80 chain

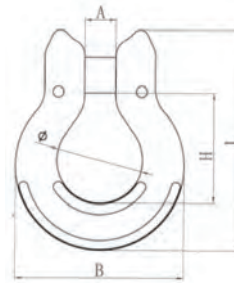

SIZE (mm)	DIMENSIONS					W.L.L (T)	WEIGHT (kg)
	A	B	H	L	Φ		
6	8.0	41.0	25.5	52.0	20.5	1.12	0.09
7/8	10.0	52.0	34.4	68.0	23.5	2	0.16
10	12.0	62.0	40.7	81.0	31.5	3.15	0.32
13	15.5	81.0	54.0	108.0	41.0	5.3	0.71
16	19.0	99.0	63.8	126.0	47.5	8	1.20
20	23.0	118.0	75.6	152.0	58.0	12.5	2.20

G80 TWIST EYE CHOKE HOOK

- Material, forged super alloy steel
- 100% magnaflux crack detection
- Sampling break test for each lot
- 100% tested at 2.5 times working load limit
- Fatigue tested at 15 times working load limit for 20000 cycles
- Ultimate load is 4 times working load limit

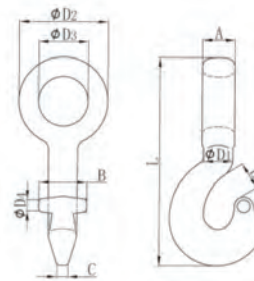

SIZE (mm)	DIMENSIONS (mm)									W.L.L (T)	WEIGHT (kg)
	A	B	C	D1	D2	D3	D4	E	L		
7/8	19.0	28.0	6.5	17.0	52.0	30.5	7.5	16.2	123.0	2.0	0.36
10	25.4	39.0	4.8	19.5	68.0	39.0	8.0	21.7	157.0	3.15	0.72
13	34.0	43.0	6.7	26.0	84.5	51.5	9.5	27.1	195.0	5.3	1.40
16	51.0	45.5	8.8	32.0	107.0	63.0	10.9	29.4	245.1	8.0	3.17
18	49.5	53.0	12.0	33.5	121.0	75.0	12.0	37.0	268.0	10.0	3.80
20/22	71.0	80.0	14.5	52.0	146.0	84.0	14.5	47.4	366.0	15.0	8.65

G80 CLEVIS LARGE OPENING HOOK

- Material forged super alloy steel
- 100% magnaflux crack detection
- Sampling break test for each lot
- 100% tested at 2.5 times working load limit
- Pins are 100% eddy-current test flaw detection
- Ultimate load is 4 times working load limit
- Fatigue tested at 1.5 times working load limit for 20000 cycles
- Suitable for EN818-2 G80 chain

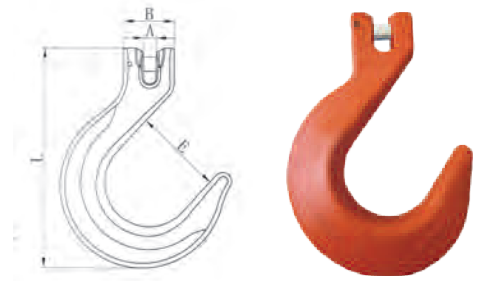

SIZE (mm)	DIMENSIONS				W.L.L (T)	WEIGHT (kg)
	A	B	E	L		
6	8.5	32.5	53.3	140.0	1.12	0.68
8	9.5	37.0	64.4	159.5	2.0	0.95
10	12.0	48.8	77.3	203.0	3.15	1.95
13	15.8	56.6	91.0	245.0	5.3	3.38
16	18.5	71.5	102.8	285.7	8.0	5.60
18	24.0	88.5	106.0	272.0	10.0	8.00
22	24.7	102	136	402	15	16.5

Ultimate load is 4 times working load limit, proof load is 2.5 times working load limit.

G80 LARGE OPENING EYE HOOK

- Material forged super alloy steel
- 100% magnaflux crack detection
- Sampling break test for each lot
- 100% tested at 2.5 times working load limit
- Fatigue tested at 1.5 times working load limit for 20000 cycles
- Suitable for EN818-2 G80 chain

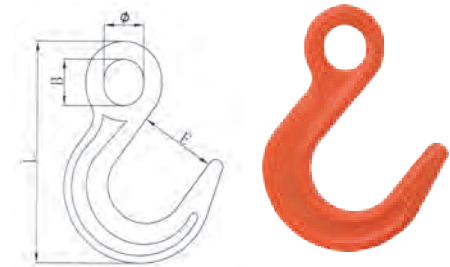

DIMENSIONS (mm)				W.L.L (T)	WEIGHT (kg)
B	E	L	Φ		
27.8	60.5	157.8	23.8	2	0.78
36.0	60.0	172.5	31.0	3.2	1.05
36.1	76.8	197.5	31.0	3.8	1.32
44.0	85.2	245.0	40.0	5.4	2.70
53.0	94.0	287.9	49.0	8	4.92
65.6	106.0	329.2	61.6	12.5	6.80

G80 EYE LOCKING HOOK

- Material Forged super alloy steel
- 100% tested 2.5 times working load limit
- 100% magnaflux crack detection
- Sampling break test for each lot
- Fatigue tested at 1.5 times working load limit for 20000 cycles
- Suitable for EN818-2 G80 chain

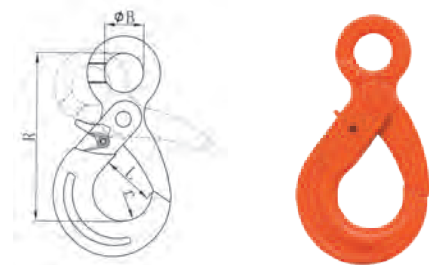

SIZE (mm)	DIMENSIONS (mm)				W.L.L (T)	WEIGHT (kg)
	B	L	R	r		
6	22.0	28.3	109.5	16.5	1.12	0.50
7/8	24.9	33.2	136.9	21.0	2	0.86
10	32.0	43.1	165.7	27.5	3.15	1.52
13	40.0	51.5	108.0	33.6	5.3	3.15
16	56.0	61.6	152.7	38.5	8	5.72
20	62.6	84.0	268.8	47.8	12.5	8.10
22	70.0	77.4	312.3	47.4	15	11.7
26	80.5	97.6	360.0	53.4	21.2	19.1
32	104.5	140.5	465.6	81.9	31.5	45.1

G80 CLEVIS SELF LOCKING HOOK

- Material Forged super alloy steel
- 100% tested 2.5 times working load limit
- 100% magnaflux crack detection
- Sampling break test for each lot
- Fatigue tested at 1.5 times working load limit for 20000 cycles
- Pins are 100% eddy-current test flaw detection
- Suitable for EN818-2 G80 chain

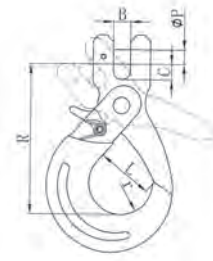

SIZE (mm)	DIMENSIONS (mm)						W.L.L (T)	WEIGHT (kg)
	B	C	L	P	R	r		
6	9.2	7.4	28.3	7.8	96.2	16.5	1.12	0.49
7/8	9.5	9.3	33.2	9.4	119.5	21.0	2	0.89
10	12.8	15.0	43.1	13.0	142.3	27.5	3.15	1.48
13	14.5	18.0	51.5	16.0	185.1	33.6	5.3	3.20
16	19.0	20.5	61.6	20.0	217.5	38.5	8	6.01
20	25.4	26.0	84.0	24.0	228.2	47.8	12.5	8.38
22	24.5	26.0	77.4	88.0	269.9	47.4	15	11.88
26	30.0	32.2	97.1	32.6	317.8	53.4	21.2	19.34
32	36.0	40.7	140.5	40.0	407.5	81.9	31.5	49.19

G80 SWIVEL SELF LOCKING HOOK WITH BEARING

- Material Forged super alloy steel
- 100% tested 2.5 times working load limit
- 100% magnaflux crack detection
- Sampling break test for each lot
- Fatigue tested at 1.5 times working load limit for 20000 cycles
- Suitable for EN818-2 G80 chain

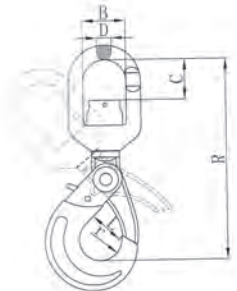

SIZE (mm)	DIMENSIONS (mm)						W.L.L (T)	WEIGHT (kg)
	L	R	r	B	C	D		
6	28.3	151.6	16.5	32.0	33.3	10.9	1.12	0.75
7/8	33.2	189.7	21.0	37.0	40.5	14.0	2	1.24
10	43.1	230.0	27.5	48.0	47.7	18.0	3.15	2.35
13	51.5	285.8	33.6	57.5	60.2	20.8	5.3	4.27
16	61.6	334.0	38.5	73.0	66.2	24.9	8	8.25
20	84.0	356.5	47.8	71.0	63.0	26.0	12.5	11.20
22	77.4	450.0	47.4	96.0	90.5	33.0	15	18.08
26	97.1	544.0	53.4	122.0	115.0	42.0	21.2	23.00
32	168.0	679.0	81.9	140.0	146.0	52.0	31.5	81.00

G80 SWIVEL SELF LOCKING HOOK WITH BUSHING

- Material Forged super alloy steel
- 100% tested 2.5 times working load limit
- 100% magnaflux crack detection
- Sampling break test for each lot
- Fatigue tested at 1.5 times working load limit for 20000 cycles
- Suitable for EN818-2 G80 chain

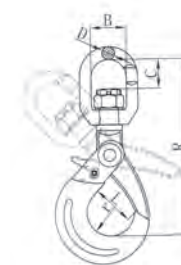

SIZE (mm)	DIMENSIONS						W. L. L (T)	WEIGHT (kg)
	L	R	r	B	C	D		
6	28.3	148.8	16.5	32.5	24.4	11.3	1.12	0.75
7/8	33.2	181.8	21.0	35.0	26.9	12.7	2	1.17
10	43.1	216.3	27.5	42.0	33.2	15.5	3.15	2.00
13	51.5	268.8	33.6	49.4	42.0	16.5	5.3	3.80
16	61.6	324.5	38.5	61.9	57.0	22.5	8	7.80
20	84.0	356.5	47.8	71.0	59.5	26.0	12.5	10.55
22	77.4	453.9	47.4	96.0	94.4	33.0	15	17.60
26	96.4	523.4	53.4	122.0	120.5	50.0	21.2	23.00
32	168.0	679.0	81.9	140.0	146.0	52.0	31.5	81.00

G80 CLEVIS SLING HOOK WITH LATCH

- Material: Forged super alloy steel
- 100% tested at 2.5 times working load limit
- 100% magnallux crack detection
- Sampling break test for each lot
- Fatigue tested at 1.5 times working load limit for 20000 cycles
- Pins are 100% eddy-current test flaw detection
- Suitable for EN818-2 G80 chain

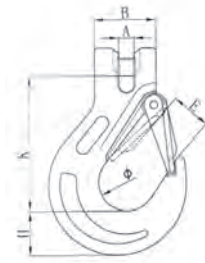

SIZE (mm)	DIMENSIONS (mm)						W.L.L (T)	WEIGHT (kg)
	A	B	K	H	Φ	E		
6	7.5	31.4	69.6	21	30	19.0	1.12	0.26
7/8	9.5	37	88.5	26.3	38.6	24.5	2	0.51
10	12.0	48	105.5	34.3	44.6	31.0	3.15	1.08
13	15.8	56.5	125.6	40.6	55.3	39.5	5.3	1.92
16	18.5	71.5	156	47.5	64	44.5	8	3.37
20	24	88.3	186.5	56.7	75.4	51.0	12.5	6.62
22	28	90	208.8	63.2	98	63.5	15	9.60
26	31.0	116	246.1	74.9	114	76.5	21.2	15.60
32	35	150	317	88	140	80.0	31.5	25.50

G80 EYE SLING HOOK WITH LATCH

- Material: Forged super alloy steel
- 100% tested at 2.5 times working load limit
- 100% magnallux crack detection
- Sampling break test for each lot
- Fatigue tested at 1.5 times working load limit for 20000 cycles
- Pins are 100% eddy-current test flaw detection
- Suitable for EN818-2 G80 chain

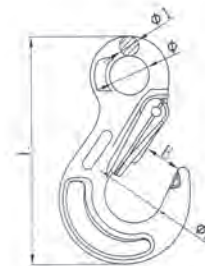

SIZE (mm)	DIMENSIONS					W.L.L (T)	WEIGHT (kg)
	Φ	Φ1	L	E	D		
6	20	10	116	19.0	30	1.12	0.26
7/8	25	11.6	141.5	24.5	38.6	2	0.52
10	34.5	16	173.2	31.0	44.6	3.15	1.09
13	43	19	217.1	39.5	55.3	5.3	2.26
16	50	25	252	44.5	64	8	3.23
20	61	26	304.8	55.5	87.4	12.5	6.79
22	68.3	30	343.9	60.0	97.9	15	9.61
26	63	38	392.5	78.0	112.5	21.2	12.41
32	88	37	480.5	85.0	140	31.5	17

G80 CLEVIS SLING HOOK LARGE FORMAT

- Material: Forged super alloy steel
- 100% tested at 2.5 times working load limit
- 100% magnallux crack detection
- Sampling break test for each lot
- Fatigue tested at 1.5 times working load limit for 20000 cycles
- Pins are 100% eddy-current test flaw detection
- Ultimate load is 4 times Working load limit

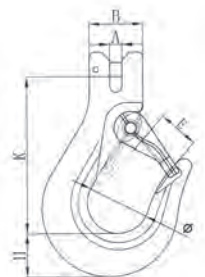

SIZE (mm)	DIMENSIONS (mm)						W.L.L (T)	WEIGHT (kg)
	A	B	H	K	Emin	Φ		
6	7.6	34.0	28.4	97.2	18.0	39.0	1.12	0.85
7/8	9.2	40.0	32.5	117.5	21.0	46.3	2	1.18
10	11.0	50.0	42	122.9	27.0	51.8	3.15	1.94
13	14.5	61.0	48	171	35.0	74.0	5.3	3.98

G80 EUROPEAN TYPE EYE GRAB HOOK WITH SAFETY HOOK

- Material: Forged super alloy steel
- 100% tested at 2.5 times working load limit
- 100% magnallux crack detection
- Sampling break test for each lot
- Fatigue tested at 1.5 times working load limit for 20000 cycles
- Pins are 100% eddy-current test flaw detection
- Suitable for EN818-2 G80 chain

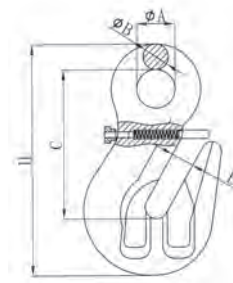

SIZE (mm)	DIMENSIONS (mm)					W.L.L (T)	WEIGHT (kg)
	A	B	C	H	E		
6	16.0	9.5	55.6	84.1	8.5	1.12	0.20
8	20.0	12.8	70.8	106.0	10.0	2.0	0.43
10	22.0	15.4	88.0	133.5	13.0	3.15	0.86
13	27.5	18.5	106.6	165.3	16.5	5.3	1.75

G80 CLEVIS SLING HOOK LARGE FORMAT

- Material: Forged super alloy steel
- 100% tested at 2.5 times working load limit
- 100% magnallux crack detection
- Sampling break test for each lot
- Fatigue tested at 1.5 times working load limit for 20000 cycles
- Pins are 100% eddy-current test flaw detection
- Ultimate load is 4 times Working load limit

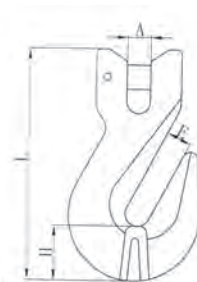

SIZE (mm)	DIMENSIONS (mm)				W.L.L (T)	WEIGHT (kg)
	A	E	H	L		
6	8.0	8.0	18.5	76.5	1.12	0.21
7/8	9.5	10.9	21.0	90.7	2	0.36
10	12.6	13.5	29.5	124.4	3.15	0.76
13	15.3	17.0	41.8	160.6	5.3	1.68
16	19.5	19.5	44.0	182.3	8	2.89
20	24.0	24.0	54.8	215.7	12.5	4.95
22	27.0	28.1	67.6	252.2	15	7.94
26	30.0	30.0	78.5	304.5	21.2	12.93

Ultimate load is 4 times working load limit, proof load is 2.5 times working load limit. • Above working load limit is based on side pull.

G80 EYE SHORTNING GRAB HOOK

- Material: Forged super alloy steel
- 100% tested at 2.5 times working load limit
- 100% magnallux crack detection
- Sampling break test for each lot
- Fatigue tested at 1.5 times working load limit for 20000 cycles
- Suitable for EN318-2 G80 chain

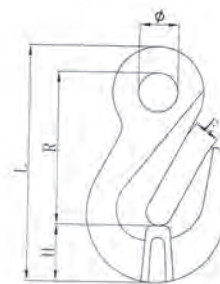

SIZE (mm)	DIMENSIONS (mm)					W.L.L (T)	WEIGHT (kg)
	R	H	E	Φ	L		
6	49.2	18.5	8.0	13.5	76.0	1.12	0.17
7/8	59.7	21.0	11.0	17.0	90.3	2	0.28
10	77.8	29.0	13.2	20.0	120.0	3.15	0.64
13	97.9	42.8	16.6	26.0	155.8	5.3	1.42
16	106.4	43.6	19.4	30.0	167.3	8	2.20
20	140.0	54.8	24.2	37.0	217.3	12.5	4.19
22	162.2	68.0	28.0	44.0	255.2	15	7.24
26	193.5	78.5	30.0	49.0	304.5	21.2	10.42
32	227.0	95.4	38.0	57.0	360.4	31.5	19.40

G80 CONTAINER HOOK

- Material: Forged super alloy steel
- 100% tested at 2.5 times working load limit
- 100% magnaflux crack detection
- Sampling break test for each lot
- Fatigue tested at 1.5 times working load limit for 20000 cycles
- Suitable for EN318-2 G80 chain

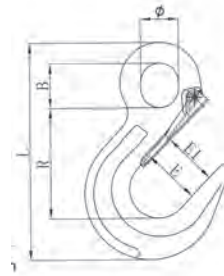

DIMENSIONS (mm)						W.L.L (T)	WEIGHT (kg)
B	L	E	E1	R	Φ		
26.5	149.0	47.0	39.0	83.2	24.0	2	0.70
35.5	179.0	49.0	40.0	94.8	30.0	3	1.28
38.5	198.0	52.0	45.0	105.5	33.5	5	1.71
16.6	227.4	61.6	57.0	115.6	39.5	6	2.46
52.0	250.0	68.0	60.0	127.3	43.0	8	3.42

WIDE MOUTH HOOK

- Material: Forged alloy steel
- Ultimate load is 2 times the working load limit
- Only for general hoist, not for overhead lifting

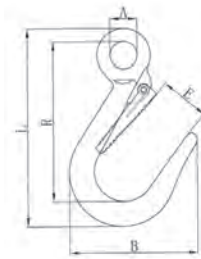

DIMENSIONS (mm)					W.L.L (T)	WEIGHT (kg)
A	B	E	L	R		
22.0	104.5	37.0	160.7	130.0	5000	0.48
24.0	105.0	40.0	169.0	133.5	7000	0.78

G80 EYE TUBE HOOK

- Material: Forged super alloy steel
- 100% magnaflux crack detection
- Sampling break test for each lot
- Suitable for EN818-2 G80 chain

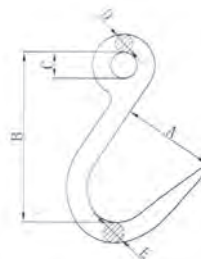

DIMENSIONS (mm)					W.L.L (T)	WEIGHT (kg)
A	B	C	D	E		
76.2	104.5	21.7	14.9	17.8	1	0.55

G80 CLEVIS TUBE HOOK

- Material: Forged super alloy steel
- 100% magnaflux crack detection
- Sampling break test for each lot
- Suitable for EN918-2000 chain
- Pins are 100% eddy-current test flaw detection

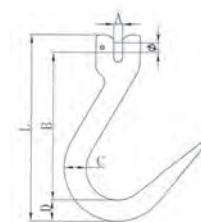

SIZE (mm)	DIMENSIONS (mm)						WEIGHT (kg)
	A	B	C	D	L	L	
1.12T	7.6	126.9	19.4	18.3	7.8	160.3	0.60
2T	9	155.1	33	31	9	205	1.78
3.15T	12	187	41	38	13	248.5	3.69

G80 EYE HOOK

- Material: Forged super alloy steel
- 100% tested at 2.5 times working load limit
- 100% magnallux crack detection
- Sampling break test for each lot
- Fatigue tested at 1.5 times working load limit for 20000 cycles
- Suitable for EN818-2 G80 chain

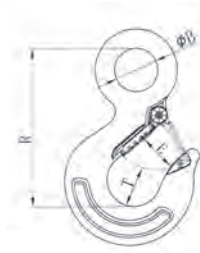

DIMENSIONS (mm)				W.L.L (T)	WEIGHT (kg)
R	B	E	T		
85	19.2	22.6	22.1	1T	0.32
96.7	23.2	23.1	25	1.5T	0.45
105	28.7	25.4	26.2	2T	0.75
119	31.8	27.7	29.5	3T	1.03
147	39.6	34.5	38.9	5T	1.97
187	51	40.9	48	7T	3.95
230	62	53	62.5	11T	6.94
258	72	57.5	66.5	15T	11.04

Ultimate load is 4 times working load limit, proof load is 2.5 times working load limit.

G80 EYE HOOK (ITALIAN TYPE)

- Material: Forged super alloy steel
- 100% tested at 2.5 times working load limit
- 100% magnallux crack detection
- Sampling break test for each lot
- Fatigue tested at 1.5 times working load limit for 20000 cycles
- Suitable for EN818-2 G80 chain

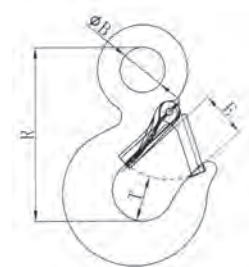

DIMENSIONS				W.L.L (T)	WEIGHT (kg)
B	Emin	R	T		
10.0	-	39.5	-	0.25	0.04
13.0	-	50.8	-	0.5	0.08
16.0	16.0	62.5	16.0	0.8	0.14
18.0	18.0	71.5	18.0	1.12	0.21
22.0	21.0	85.0	21.0	1.5	0.34
26.0	25.0	99.8	25.0	2	0.59
28.0	28.0	108.0	28.0	2.5	0.68
30.0	30.0	119.2	30.0	3.15	0.97
33.0	33.0	127.0	33.0	4	1.20
37.0	37.0	142.0	37.0	5.3	1.65
40.0	39.0	152.0	39.0	6	2.00
47.0	46.0	181.0	46.0	8	3.30
52.0	50.0	195.0	50.0	10	4.00

G80 SWIVEL HOOK WITH BEARING

- Material: Forged super alloy steel
- 100% magnallux crack detection
- Sampling break test for each lot
- Ultimate load is 4 times working load limit

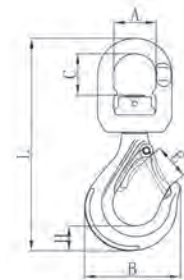

SIZE (mm)	DIMENSIONS						W.L.L (T)	WEIGHT (kg)
	A	B	C	E	H	L		
6	32	72.2	32.3	26.0	19.5	165.6	1.12	0.61
7/8	37	88.2	40.5	30.3	24.8	204.1	2	1.11
10	48	105.5	45.7	33.6	28	248.6	3.15	1.98
13	57.5	133.8	60.3	40.2	39.5	308.8	5.3	3.54
16	73	164.1	62.3	47.1	43	353.4	8	6.58

G80 SWIVEL HOOK WITH LATCH

- Material: Forged super alloy steel
- 100% magnallux crack detection
- Sampling break test for each lot
- Fatigue tested at 1.5 times working load limit for 20000 cycles
- Ultimate load is 4 times working load limit

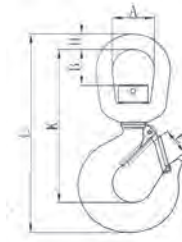

SIZE (mm)	DIMENSIONS						W.L.L (T)	WEIGHT (kg)
	A	E	B	H	K	L		
6	31.8	20.5	24.0	9.6	112.0	141.5	1.12	0.40
8	44.5	22.0	42.5	15.9	152.0	194.2	2.0	1.03
10	44.5	28.4	43.0	15.9	161.0	207.5	3.15	1.29
13	50.8	34.0	44.8	19.1	189.3	245.5	5.3	2.33
16	63.5	42.9	62.0	25.4	244.5	316.7	8.0	4.72
20	70.0	52.2	65.5	28.8	286.9	372.8	12.5	7.37
22	79.0	57.0	70.3	31.8	305.0	405.0	15.0	12.15
26	102.0	76.5	104.8	41.0	425.9	542.0	21.2	23.6
32	105.0	82.5	105.0	40.0	472.0	596.0	31.5	32.00

G80 SWIVEL HOOK WITH BEARING

- Material: Forged super alloy steel
- 100% magnallux crack detection
- Sampling break test for each lot
- 100% tested at 25 times working load limit
- Fatigue tested at 1.5 times working load limit for 20000 cycles
- Ultimate load is 4 times working load limit

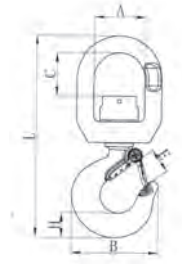

DIMENSIONS (mm)						W.L.L (T)	WEIGHT (kg)
A	B	C	E	H	L		
42.0	71.9	35.8	22.6	18.7	178.6	1	0.95
53.0	90.0	44.9	25.4	25.4	209.9	2	1.58
53.0	101.3	44.9	27.7	28.7	224.0	3	1.83
61.0	125.8	59.3	34.5	36.6	291.4	5	3.75
71.0	160.8	63.7	40.9	46.0	337.0	7	6.23
85.0	192.0	71.5	52.8	57.0	400.0	11	10.11
102.0	211.4	110.8	57.7	65.8	501.0	15	19.36

G80 SWIVEL HOOK WITH BUSHING

- Material: Forged super alloy steel
- 100% magnallux crack detection
- Sampling break test for each lot
- 100% tested at 25 times working load limit
- Fatigue tested at 1.5 times working load limit for 20000 cycles
- Ultimate load is 4 times working load limit

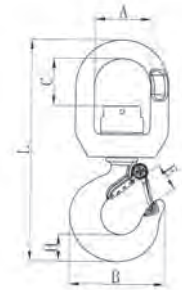

DIMENSIONS (mm)						W.L.L (T)	WEIGHT (kg)
A	B	C	E	H	L		
42.0	71.9	35.8	22.6	18.7	178.6	1	0.95
53.0	90.0	44.9	25.4	25.4	209.9	2	1.58
53.0	101.3	44.9	27.7	28.7	224.0	3	1.83
61.0	125.8	59.3	34.5	36.6	291.4	5	3.75
71.0	160.8	63.7	40.9	46.0	337.0	7	6.23
85.0	192.0	71.5	52.8	57.0	400.0	11	10.11
102.0	211.4	110.8	57.7	65.8	501.0	15	19.36

G80 CONTAINER LIFTING

- Forged super alloy steel-quenched and tempered
- Suitable for web sling and G80 chain EN818-2
- Individually proof test at 2.5times working load limit
- Faluge tested at 1.5 times working load limit for 20000 cycles
- Sampling break test for each
- 100% magnaflux crack detection
- All load pins are 100% individually inspected & tested

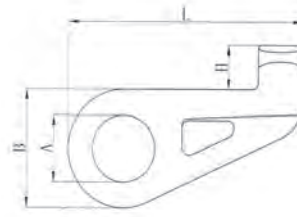

TYPE	DIMENSIONS (mm)				W.L.L (T)	WEIGHT (kg)
	A	B	H	L		
LEFT	68.0	120.4	45.0	254.2	12.5	4.33
RIGHT	68.0	120.4	45.0	254.2	12.5	4.33
STRAIGHT	68.0	120.4	45.0	254.2	12.5	4.33

G80 CLEVIS CHOKE HOOK

- Forged super alloy steel-quenched and tempered
- Suitable for web sling and G80 chain EN818-2
- Individually proof test at 2.5times working load limit
- Faluge tested at 1.5 times working load limit for 20000 cycles
- Sampling break test for each
- 100% magnaflux crack detection
- All load pins are 100% individually inspected & tested

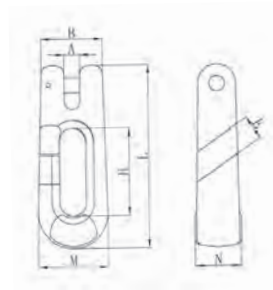

SIZE (mm)	DIMENSIONS (mm)							WEIGHT (kg)
	A	B	H	M	N	E	L	
8	10.4	41.0	58.5	46.5	31.0	16.0	122.0	0.66
10	13.1	41.5	59.8	55	37	17.0	130.1	0.85

A342 FORGED ALLOY MASTER LINKS

- Material: Forged super alloy steel
- 100% tested at 2.5 times working load limit
- 100% magnaflux crack detection
- Samping break test for each lot
- For chain sling: minimum ultimate load is 4 times the working load limit
- For steel rope sling: minimum ultimate load is 5 times the working load limit
- There will be pressing flat only on request
- All sizes: There will be pressing flat only on request

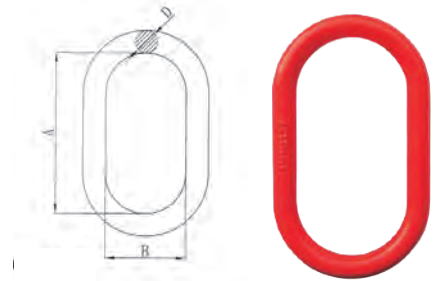

SIZE (Mm)	Weight (Kg)	American Chain	A Chain Of Work Load	Two Chain Working Load (The Angle 0-45°)	Rope Working Load (T)	A	B	D	Regular Marking
1/2	0.38	1/4 5/16	1.5 2	2.12 2.8	3.4	127±6	63.5±5	14±1	WLL2.8T
5/8	0.70	5/16 3/8	2 3.15	2.8 -	4	152±6	76±5	16±1	WLL3.15T
3/4	0.94	3/8 3/8	3.15 3.15	4.25 4.25	5.6	140±6	70±5	19±1	WLL4.25T
7/8	1.48	1/2 1/2	5.3 5.3	- 7.5	6.9	160±6	90±5	22±1	WLL5.3T
1	2.09	5/8 5/8	8 8	11.2 11.2	11.8	178±6	89±5	25±1	WLL11.2T
1-1/4	4.09	3/4 3/4	11.2 11.2	16 16	17.7	222±7	111±6	32 ⁺¹ ₋₂	WLL16T
1-1/2	7.19	7/8 7/8	16 16	21.2 21.2	27.7	267±7	135±6	38 ⁺¹ ₋₂	WLL21.2T
1-3/4	11.28	1 1	21.2 21.2	- 30	38.5	305±10	152±6	54 ⁺¹ ₋₂	WLL21.2T
2	16.75	1 1/4 1 1/4	- 30	- 45	46.5	355±10	178±6	51 ⁺¹ ₋₂	WLL31.5T
2-1/4	22.24	-	-	-	64.9	406±10	203±7	57 ⁺¹ ₋₂	WLL45T
2-1/2	30.38	-	-	-	72.6	406±10	203±7	63.5±3	WLL72.6T
2-3/4	41.77	-	-	-	98.4	406±10	241±7	70±3	WLL98.4T
3	49.87	-	-	-	103	457±15	228±7	76±3	WLL103T
3-1/4	65.66	-	-	-	119	508±15	254±7	82.5±3	WLL119T
3-1/2	77.41	-	-	-	126	610±15	305±10	89±3	WLL126T
3-3/4	89.24	-	-	-	152	508±15	254±7	95±3	WLL152T
4	104.29	-	-	-	169	508±15	254±7	102±3	WLL169T
4-1/4	137.14	-	-	-	160	610±15	305±7	108±3	WLL160T
4-1/2	175.40	-	-	-	163	711±18	356±7	114±3	WLL163T
4-3/4	199.29	-	-	-	176	711±18	356±7	121±4	WLL176T
5	234.40	-	-	-	179	762±20	381±10	127±4	WLL179T

A343 EUROPEAN TYPE MASTER LINK WITH FLAT

- Material: Forged super alloy steel
- 100% tested at 2.5 times working load limit
- 100% magnaflux crack detection
- Sampling break test for each lot
- Fatigue tested at 1.5 times working load limit for 20000 cycle
- Standard: EN1677-4
- Ultimate load is 4 times the working load limit
- For use with wire rope sling, refer to DIN3058 standard
- For use with synthetic sling, refer to EN1492-1 standard

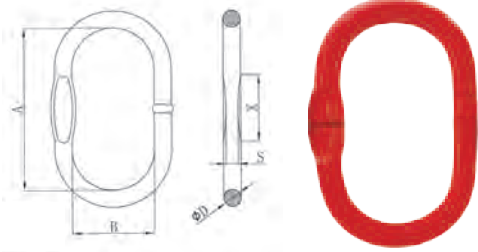

G80 EN818-2 CHAIN		DIMENSIONS (mm)					W.L.L (T)	WEIGHT (kg)
For 1 Leg (mm)	For 2 Legs (mm)	A	B	D	S	X		
7	6	110+6	60+5	13±1	8 ^{+0.3} ₋₀	25.0	1.6	0.34
8	7	110+6	60+5	16±1	7 ^{+1.5} ₋₀	25.5	2.12	0.54
10	8	135+6	75+5	18±1	7 ^{+0.5} ₋₀	28.0	3.15	0.82
13	10	160+6	90+5	22±1	11±0.5	35.0	5.3	1.50
16	13	180+6	100+6	26±1	13±0.5	43.0	8	2.32
18	16	200+6	110+6	32 ⁺¹ ₋₂	17±0.5	55.0	11.2	3.95
20	18	260+7	140+6	36 ⁺¹ ₋₂	19±0.5	60.0	14	6.34
22	20	300+7	160+6	40 ⁺¹ ₋₂	20±0.5	64.0	17	8.96
26	22	340+10	180+6	45 ⁺¹ ₋₂	23±0.5	70.0	21.2	12.40
32	26	350+10	190+6	50 ⁺¹ ₋₂	26±0.5	83.0	31.5	16.32
36	32	400+10	200+6	56 ⁺¹ ₋₂	32±0.5	105.0	45	22.66
40	36	430+10	220+7	63±3	36±0.5	116.0	56	32.00
45	40	460+15	250+7	72±3	45±0.5	230.0	63	45.76

A344 US TYPE MASTER LINK (WELDED)

- Material: forged super alloy steel
- 100% tested at 2.5 times working load limit
- 100% magnaflux crack detection
- Sampling break test for each lot
- For chain sling: Minimum ultimate load is 4 times the working load limit
- For steel rope sling: Minimum ultimate load is 5 times the working load limit

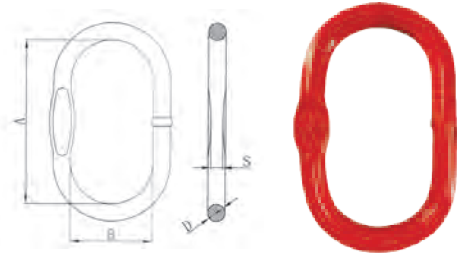

SIZE (Mm)	Weight (Kg)	American Chain	A Chain Of Work Load (The)	Two Chain Working Load (The Angle 0-45°)	Rope Working Load (T)	A	B	D	S	Regular Marking
7/6	0.27	1/4	1.12	1.6	1.6	100±5	60±5	12±1	6±0.5	WLL1.6T
1/2	0.38	9/32	1.5	2.12	2.5	100±5	60±5	14±1	7.6±0.5	WLL2.12T
		5/16	2	-						
11/16	0.91	5/16	2	2.8	4	160±6	90±5	18±1	8.4±0.5	WLL3.15T
		3/8	3.15	-						
3/4	1.20	3/8	3.15	4.25	6.5	160±6	90±5	20±1	10.5±0.5	WLL5.3T
		1/2	5.3	-						
7/8	1.65	1/2	5.3	7.5	8	180±6	100±5	22±1	13.5±0.5	WLL8T
		5/8	8	-						
1	2.13	5/8	8	11.2	11.5	180±6	100±5	25±1	16.5±0.5	WLL11.2T
		19mm	11.2	-						
1.1/8	3.81	3/4	12.5	-	11.8	270±7	140±6	28 ⁺¹ ₋₂	19±0.5	WLL12.5T
		19mm	11.2	16						
1.1/4	5.05	7/8	15	-	16	270±7	140±6	32 ⁺¹ ₋₂	19±0.5	WLL16T
		7/8	15	21.2						
1.3/8	6.83	1	21.2	-	24	285±7	155±6	36 ⁺¹ ₋₂	20±0.5	WLL21.2T
		28mm	25	-						
1.1/2	8.90	1	21.2	30	25	300±8	160±6	40 ⁺¹ ₋₂	26±0.5	WLL25T
		30	-							
1.3/4	12.80	1.1/4	31.5	-	31.5	340±10	180±6	45 ⁺¹ ₋₂	26±0.5	WLL31.5T
		31.5	-							
2	17.30	1.1/4	31.5	45	45	390±10	215±7	51 ⁺¹ ₋₂	32±0.5	WLL45T

G80 MASTER LINK

- Material: forged super alloy steel
- 100% tested at 2.5 times working load limit
- 100% magnaflux crack detection
- Sampling break test for each lot
- Fatigue tested at 1.5 times working load limit for 20000 cycles
- Ultimate load is 4 times the working load limit

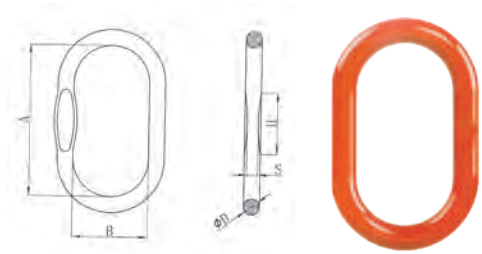

SIZE (mm)	DIMENSIONS					W.L.L (LBS)	WEIGHT (kg)
	A	B	D	S	H		
13B6	115	60	13	10	20	2.4	0.35
16B6	120	70	16	12	24	3.8	0.58
16B7	190	100	16	12	24	2.8	0.86
18B6	150	80	18	13.5	27	4	0.89
18B7	170	90	18	13.5	27	4	1.00
20B7	170	90	20	15	30	5.8	1.25
22B6	170	90	22	17	33	7.6	1.53
22B7	210	110	22	17	33	6.4	1.83
22B8	270	140	22	17	33	5.8	2.29
25B6	190	100	25	19	37	10	2.20
25B7	270	140	25	19	37	8	3.00
28B7	270	140	28	23	45	10.5	3.80
32B6	270	140	32	26	48	15.2	5.05
38B6	270	140	38	29	50	25.1	7.29
38B7	420	220	38	29	50	17	10.77
45B6	320	170	415	34	68	34	12.77
45B7	470	250	145	34	68	24.5	17.05
50B6	380	200	50	40	75	40	17.64
60B6	430	220	60	45	90	58	28.82
70B6	500	250	70	52	105	84	45.44

A345 US TYPE MASTER LINK ASSEMBLY

- Material: forged super alloy steel
- 100% tested at 2.5 times working load limit
- 100% magnaflux crack detection
- Sampling break test for each lot
- For chain sling: Minimum ultimate load is 4 times the working load limit
- For steel rope sling: Minimum ultimate load is 5 times the working load limit
- There will be pressing flat only on request

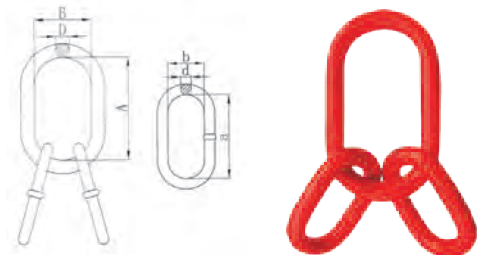

Size (mm)	WEIGHT (kg)	American Chain	3 or 4 Chain Working Load (The Angle 0-45°)	Rope Working Load (T)	A	B	D	a	b	d	Regular Marking
3/4	1.70	1/4 5/16	3.15 4.25	5.6	140±6	70±5	20±1	85±5	40±3	14±1	WLL4.25T
7/8	2.18	5/16 3/8	4.25 6.7	6.9	160±6	95±5	22±1	85±5	40±5	14±1	WLL6.7T
1	3.31	3/8	6.7	11.8	178±6	89±5	25±1	100±5	60±5	18±1	WLL6.7T
1 1/4	6.08	1/2 5/8	11.2 17	17.7	220±7	110±6	32 ⁺¹ ₋₂	100±5	60±5	22±1	WLL17T
1 1/2	12.28	5/8 3/4	17 23.6	27.7	267±7	135±6	38 ⁺¹ ₋₂	180±6	100±5	30 ⁺¹ ₋₂	WLL23.6T
1 3/4	18.63	3/4 7/8	23.6 31.5	38.5	305±10	152±6	45 ⁺¹ ₋₂	180±6	100±5	32 ⁺¹ ₋₂	WLL31.5T
2	27.14	7/8	31.5	46.5	356±10	178±6	50 ⁺¹ ₋₂	180±6	100±5	38 ⁺¹ ₋₂	WLL31.5T
2 1/2	64.40	1	45	72.6	406±10	203±6	64 ⁺¹ ₋₂	355±8	178±6	51 ⁺¹ ₋₂	WLL45T
2 3/4	89.00	1 1/4	67	98.4	406±10	241±6	70 ⁺¹ ₋₂	406±8	203±6	57 ⁺¹ ₋₂	WLL67T

A346 MASTER LINK ASSEMBLY WITH FLAT

- Material: forged super alloy steel
- 100% tested at 2.5 times working load limit
- 100% magsaflux crack detection
- Sampling break test for each kit
- Fatigue tested at 1.5 times Working Load Limit for 20000 cycles
- Standard: EN1677-4
- Suitable for 3 or 4 legs GBD chain sling as per EN818-4 G80 Components
- Ultimate load is 4 times the working load limit
- For use with wire rope sing, refer to DIN3088 standard
- For use with synthetic sing, refer to EN1492-1 standard
- There will be pressing flat only on request

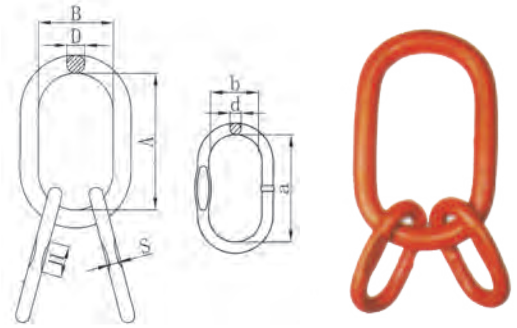

Size (mm)	WEIGHT (kg)	WLL (T)	A	B	D	a	b	d	S x H S x H	Regular Marking
6	1.18	2.36	135±6	75±5	18±1	54±5	25±3	13±1	7 ₀ ^{+0.3} X25	WLL2.36T
7	1.24	3.15	135±6	75±5	18±1	60±5	38±3	13±1	7 ₀ ^{+0.5} X25	WLL3.15T
8	2.20	4.25	160±6	90±5	22±1	70±5	34±3	16±1	8 ₀ ^{+0.5} X28	WLL4.25T
10	3.40	6.7	180±6	100±5	26±1	85±5	40±3	18±1	11±0.5X35	WLL6.7T
13	6.10	11.2	200±6	110±6	32 ⁺¹ ₋₂	115±6	50±3	22±1	13±0.5X43	WLL11.2T
16	9.50	17.0	260±7	140±6	36 ⁺¹ ₋₂	140±6	65±5	26±1	17±0.5X55	WLL17T
18	20.01	21.2	340±10	180±6	45 ⁺¹ ₋₂	180±6	100±6	32 ⁺¹ ₋₂	18±0.5X59	WLL21.2T
20	23.51	26.5	350±10	190±6	50 ⁺¹ ₋₂	180±6	100±6	32 ⁺¹ ₋₂	20±0.5X64	WLL26.5T
22	25.49	31.5	350±10	190±6	50 ⁺¹ ₋₂	180±6	100±6	36 ⁺¹ ₋₂	-	WLL31.5T
26	35.20	45	400±10	200±6	56 ⁺¹ ₋₂	180±6	100±6	40 ⁺¹ ₋₂	-	WLL45T
28	47.00	50	430±10	220±7	63±3	180±6	100±6	45 ⁺¹ ₋₂	-	WLL50T
32	66.46	63	460±10	250±7	72±3	200±6	110±6	50 ⁺¹ ₋₂	-	WLL63T

A347 US TYPE MASTER LINK ASSEMBLY (WELDED)

- Material: forged super alloy steel
- 100% tested at 2.5 times working load limit
- 100% magsaflux crack detection
- Sampling break test for each kit
- Fatigue tested at 1.5 times Working Load Limit for 20000 cycles
- Standard: EN1677-4
- Suitable for 3 or 4 legs GBD chain sling as per EN818-4 G80 Components
- Ultimate load is 4 times the working load limit
- For use with wire rope sing, refer to DIN3088 standard
- For use with synthetic sing, refer to EN1492-1 standard
- There will be pressing flat only on request

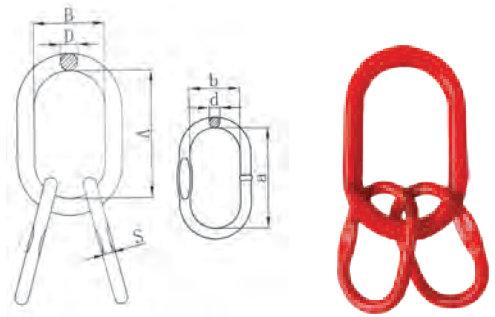

SIZE (mm)	WEIGHT (kg)	American Chain	WLL (The Angle 0-45°)	Rope Working Load	A	B	D	a	b	d	S	Regular Marking
1/2	0.82	7/32	2.36	2.4	100±5	60±5	14±1	85±5	40±3	12±1	6 ₀ +0.5	WLL2.36T
5/8	1.75	1/4	3.15	3.2	160±6	90±5	18±1	100±5	60±5	14±1	7.6±0.5	WLL3.15T
11/16	1.66	1/4	3.15	3.2	160±6	90±5	18±1	100±5	60±5	14±1	7.6±0.5	WLL3.15T
3/4	1.96	5/16	4.25	4.2	160±6	90±5	20±1	100±5	60±5	14±1	7.6±0.5	WLL4.25T
7/8	3.30	3/8	6.7	8	180±6	100±5	22±1	150±5	70±5	18±1	8.4±0.5	WLL6.7T
11/8	6.75	1/2	11.2	12	270±7	140±6	28 ⁺¹ ₋₂	160±6	90±5	22±1	13.5±0.5	WLL11.2T
11/4	9.31	5/8	17	17	270±7	140±6	32 ⁺¹ ₋₂	180±6	100±5	25±1	16.5±0.5	WLL17T
11/2	18.92	3/4	23.6	25	300±7	160±6	40 ⁺¹ ₋₂	270±7	140±5	31 ⁺¹ ₋₂	19±0.5	WLL23.6T
13/4	26.60	7/8	31.5	31.5	340±10	180±6	45 ⁺¹ ₋₂	285±7	155±6	36 ⁺¹ ₋₂	22±0.5	WLL31.5T
2	42.91	1	45	45	350±10	190±6	51 ⁺¹ ₋₂	340±10	180±6	45 ⁺¹ ₋₂	25±0.5	WLL45T

G80 MASTER LINK ASSEMBLY TYPE

- Material: forged super alloy steel
- 100% tested at 2.5 times working load limit
- 100% magsaflux crack detection
- Sampling break test for each kit
- Fatigue tested at 1.5 times working load limit for 20000 cycles
- Standard: EN1677-4
- Ultimate load is 4 times the working load limit

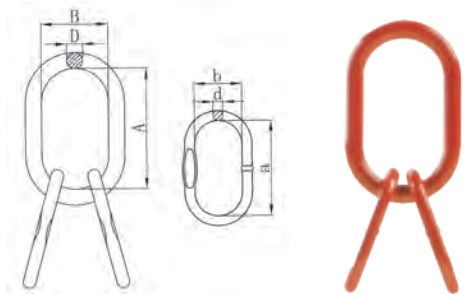

SIZE (mm)	DIMENSIONS (mm)						W.L.L (T)	WEIGHT (kg)
	A	B	D	a	b	d		
MA16	120	70	16	95	51	13	3.8	1.18
MA20	170	90	20	120	70	16	5.8	2.31
MA22	170	90	22	150	80	20	7.6	3.77
MA25	190	102	25	150	80	20	10	4.45
MA28	210	110	28	170	90	22	12.7	6.12
MA32	270	140	32	190	100	25	15.2	9.45
MA38	270	140	38	270	140	32	25	17.39
MA45	320	170	45	270	140	38	34	26.75
MA50	380	200	50	270	140	38	40	32.30
MA60	430	220	60	380	200	50	58	64.10
MA70	500	250	70	430	220	60	84	103.1

G80 CLEVIS PEAR LINK

- Material: forged super alloy steel
- 100% magnallux crack detection
- 100% leated at 2.5 times working load limit
- Sampling break test for each lot
- Pins are 100% eddy-current test naw detection
- Ultimale load is 4 times working load limit
- Fatiuge tested at 1.5 times working load limit for 20000 cycles
- Suitable for EN818-2 G80 chain

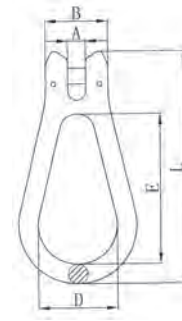

SIZE (mm)	DIMENSIONS (mm)					W.L.L (T)	WEIGHT (kg)
	A	B	D	E	L		
7/8	10.0	32.8	45.0	87.0	139.0	2.0	0.53
10	12.0	42.0	60.0	108.0	174.0	3.15	0.74
13	16.5	55.5	66.5	137.5	228.0	5.3	1.76
16	19.0	68.0	72.0	165.0	264.0	8.0	2.80
18	23.0	73.0	98.0	185.0	317.0	10.0	3.50

G80 WELDLESS ROUND RINGS

- Material: forged super alloy steel
- 100% magsaflux crack detection
- Sampling break test for each lot
- Standard: EN818-2G80 chain

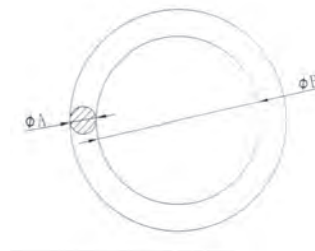

DIMENSIONS		W.L.L (T)	WEIGHT (kg)
A	B		
9.5	50.8	1	0.11
12.7	50.8	1	0.20
15.9	78.2	1.5	0.45
15.9	84	1.5	0.49
19.1	76.2	1.7	0.67
19.1	101.6	1.7	0.84
22.2	101.6	3.3	1.20
22.2	139.5	2.5	1.55
25.4	101.6	4.9	1.59
25.4	138.5	4.9	2.10
28.6	152.4	4.9	2.87
31.8	127	7.7	3.10
31.8	152.4	7.7	3.60
31.8	254.0	7.7	5.60
34.9	152.4	8.6	4.50
38.1	203.2	10.0	6.80
38.1	222.3	10.0	7.32
38.1	254.0	10.0	8.22
50.8	304.8	15.9	17.80

G80 FORGED PEAR SHAPE LINK

- Material: forged super alloy steel
- 100% magsaflux crack detection
- Sampling break test for each lot
- Standard: EN818-2G80 chain

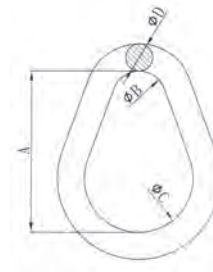

DIAMETER SOCK D		DIMENSIONS (mm)			W.L.L (T)		WEIGHT (kg)
in	mm	A	B	C	Carbon (6.1)	Alloy (5.1)	
3/8	10	57.2	19.0	38.2	0.8	1.6	0.10
1/2	13	76.2	25.4	50.8	1.3	3.2	0.25
5/8	16	95.3	31.8	63.5	1.9	4.0	0.50
3/7	19	114.0	38.1	76.2	2.7	5.6	0.80
7/8	22	133.5	44.0	89.0	3.8	6.4	1.32
1	25	152.0	50.0	102.0	4.9	11.0	1.95
1 1/8	28	171.5	57.2	114.3	5.4	13.9	2.92
1 1/4	32	190.5	64.0	127.0	7.6	16.3	3.75
1 3/8	35	209.6	69.8	139.7	9.3	19.5	5.12
1 1/2	38	228.6	76.2	152.4	11.4	24.7	6.20
1 3/4	45	266.7	88.9	177.8	-	38.5	10.20
2	51	304.8	101.6	203.2	-	46.5	15.30

G80 WIDE-BODY SHACKLE

- Material: forged super alloy steel
- 100% magsaflux crack detection
- Sampling break test for each lot
- Pins are 100% eddy-current test flaw detection
- Ultimate load is 5 times working load limit

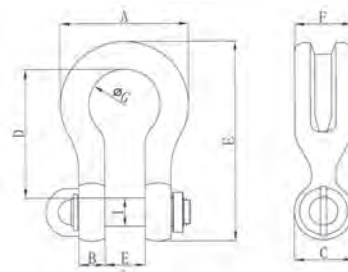

W.L.L (T)	DIMENSIONS (mm)									WEIGHT (kg)
	A	B	C	D	E	F	G	H	I	
18	180.0	30.0	69.0	147.0	52.0	64.0	102.0	239.0	35.0	7.00
30	200.0	35.0	90.0	165.0	69.0	79.0	126.0	279.0	42.0	13.00
40	235.0	45.0	109.0	199.0	84.0	97.0	140.0	331.0	51.0	21.00
55	270.0	55.0	115.0	240.0	90.0	100.0	160.0	389.0	57.0	30.00
75	317.0	54.0	125.0	290.0	110.0	120.0	185.0	473.0	70.0	48.00
125	390.0	85.0	154.0	366.0	137.0	150.0	220.0	583.0	80.0	92.00
150	424.0	89.0	179.0	391.0	147.0	170.0	253.0	645.0	65.0	140.00
200	482.0	100.0	199.0	481.0	158.0	205.0	280.0	759.0	105.0	205.00
250	530.0	110.0	227.0	542.0	179.0	240.0	300.0	859.0	120.0	264.00
300	620.0	122.0	245.0	601.0	195.0	265.0	350.0	947.0	134.0	360.00
400	690.0	145.0	293.0	576.0	231.0	320.0	370.0	985.0	160.0	580.00
500	790.0	160.0	328.0	681.0	263.0	339.0	450.0	1131.0	180.0	780.00
600	865.0	170.0	348.0	741.0	289.0	370.0	490.0	1234.0	200.0	980.00
700	901.0	190.0	392.0	751.0	315.0	400.0	540.0	1284.0	215.0	1360.00
800	947.0	200.0	420.2	851.0	342.0	420.0	554.0	1426.0	230.0	1430.00
900	1023.0	220.0	466.0	851.0	368.0	440.0	580.0	1488.0	255.0	1650.00
1000	1107.0	240.0	490.0	851.0	399.0	460.0	614.0	1532.0	270.0	2120.00
1250	1182.0	260.0	510.0	931.0	452.0	530.0	650.0	1666.0	300.0	3700.00
1500	1253.0	280.0	550.0	950.0	483.0	560.0	680.0	1710.0	320.0	4000.00

SORTING HOOK

- Material: forged super alloy steel
- 100% magsaflux crack detection
- 100% tested at 2.5 times working load limit
- Sampling break test for each lot
- Fatings tostru at 1.8 times working load limit for 20000 cycles
- Ultimate load is 4 times working load limit, working load limit at the hook is 2T, working load limit al bottom of hook is 7.5T



DIMENSIONS (mm)						W.L.L. (T)	WEIGHT (kg)
A	D	B	H	C	L		
20	35.0	166.6	48.5	33.0	252.5	2	2.99

SORTING HOOK WITH HANDLE

- Material: forged super alloy steel
- 100% magsaflux crack detection
- Sampling break test for each lot
- 100% tested at 2.5 times working load limit
- Fatiuge tested at 1.5 times working load limit for 20000 cycles
- Utimate load 4 times working road turnout
- Working load limit at the hook is: 2T, working load limit at bottom of hook is 7.5T



DIMENSIONS (mm)						W.L.L. (T)	WEIGHT (kg)
A	D	B	H	C	L		
20	35.0	166.6	48.5	33.0	252.5	2	3.12

G80 LASHING TYPE C HOOK WITH SPRING PIN

- Material: forged super alloy steel
- Sampling break test for each lot
- Utimate load is 5 times working load turnout
- Suitable for G80 lashing chain

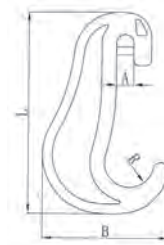

SIZE (mm)	DIMENSIONS				W.L.L. (T)	WEIGHT (kg)
	A	B	L	R		
6	22.0	28.3	109.5	16.5	1.12	0.50
7/8	24.9	33.2	136.9	21.0	2	0.86
10	32.0	43.1	165.7	27.5	3.15	1.52

G80 CHAIN LINK

- Material: forged super alloy steel

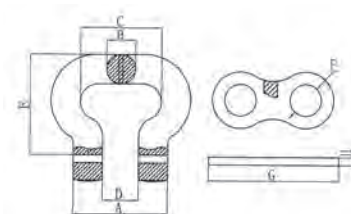

SIZE (mm)	DIMENSIONS (mm)								WEIGHT (kg)
	A	B	C	D	E	F	G	H	
12×35	39.0	10.3	36.0	19.0	43.6	11.2	59.7	2.7	0.13
13×36	42.0	13.0	36.0	16.0	50.5	14.0	68.0	4.0	0.22

DEE SHACKLES

- Forged Quenched and Tempered, with alloy pin
- Maximum Proof Load is 2.2 times the working Load limit
- Maximum Ultimate Load is 6 times the working Load limit
- G-210 with Screw pin; G-215 with Round pin; G215 is Bolt Type

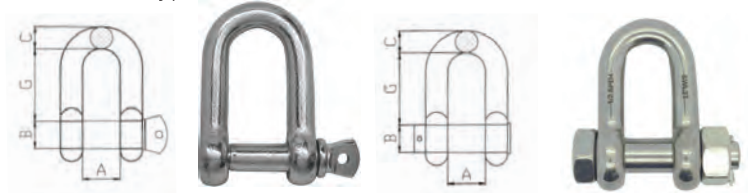

Size of Chain		Dimensions (mm)				W. L. L (T)	Weight (kg)
in	mm	A	B	C	G		
1/4	6	12.3	7.9	7.0	21.7	0.5	0.06
5/16	8	12.8	8.4	8.1	25.3	0.75	0.10
3/8	10	17.5	11.0	10.0	30.2	1	0.15
7/16	11	19.6	11.6	11.1	36.0	1.5	0.22
1/2	13	20.5	16.0	12.7	41.0	2	0.34
5/8	16	28.0	19.0	16.0	50.5	3.25	0.67
3/4	19	32.0	22.0	19.0	60.5	4.75	1.14
7/8	22	38.5	25.0	22.0	72.0	6.5	1.74
1	25	44.5	28.0	25.0	81.0	8.5	2.52
1 1/8	29	46.0	32.0	28.5	92.0	9.5	3.45
1 1/4	32	51.0	35.0	32.0	99.0	12	4.90
1 3/8	35	58.0	38.0	35.0	114.0	13.5	6.24
1 1/2	38	60.5	42.0	38.0	122.0	17	8.39
1 3/4	45	76.6	50.0	45.0	146.0	25	14.20
2	51	83.0	57.0	51.0	172.0	35	21.20
2 1/2	63	106.5	69.0	64.0	203.0	55	38.60
3	76	128.7	82.0	77.0	216.0	85	56.00

BOW SHACKLES

- Forged Quenched and Tempered, with alloy pin
- Maximum Proof Load is 2.2 times the working Load limit
- Maximum Ultimate Load is 6 times the working Load limit
- G-209 with Screw pin; G-213 with Round pin; G2130 is Bolt Type

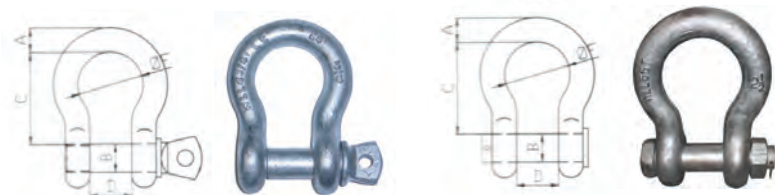

Size of Chain		Dimensions (mm)					W. L. L (T)	Weight (kg)
in	mm	A	B	C	D	F		
1/4	6	7.0	7.9	27.5	12.3	19.8	0.5	0.05
5/16	8	8.1	8.4	31.6	12.8	21.0	0.75	0.10
3/8	10	10.0	11.0	37.0	17.5	25.5	1	0.15
7/16	11	11.1	11.6	40.9	19.6	29.0	1.5	0.22
1/2	13	12.7	16.0	47.5	20.5	34.0	2	0.36
5/8	16	16.0	19.0	60.5	28.0	42.0	3.25	0.63
3/4	19	19.0	22.0	72.0	32.0	49.5	4.75	1.23
7/8	22	22.0	25.0	84.0	38.5	58.0	6.5	1.79
1	25	25.0	28.0	95.5	44.5	67.0	8.5	2.28
1 1/8	29	28.5	32.0	108.0	46.0	73.0	9.5	3.75
1 1/4	32	32.0	35.0	119.0	51.0	80.0	12	5.31
1 3/8	35	35.0	38.0	133.0	58.0	91.0	13.5	7.18
1 1/2	38	38.0	42.0	146.0	60.5	97.0	17	8.62
1 3/4	45	45.0	50.0	178.0	76.6	128.0	25	15.4
2	51	51.0	57.0	197.0	83.0	145.0	35	23.7
2 1/2	63	64.0	69.0	267.0	106.5	185.0	55	44.6
3	76	77.0	82.0	330.0	128.7	203.0	85	70.0



RIGGING HARDWARE

SHACKLE TYPE HEAVY DUTY SNATCH BLOCK

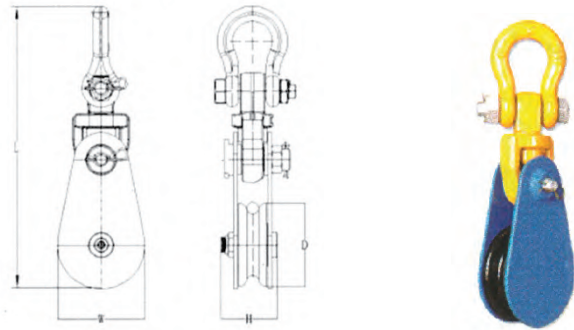

Size	Working Load Limit (T)	Sheave Diameter (in)	Wire Rope Size (mm)	Dimensions (mm)				Weight (kg)
				D	W	H	L	
3"x2T	2	3	7-9	75	76	54	237	2.2
4.5"x4T	4	4.5	10-12	115	116	71	355	6.8
6"x8T	8	6	16-19	152	155	90	495	12.2

SHACKLE TYPE HEAVY DUTY SNATCH BLOCK

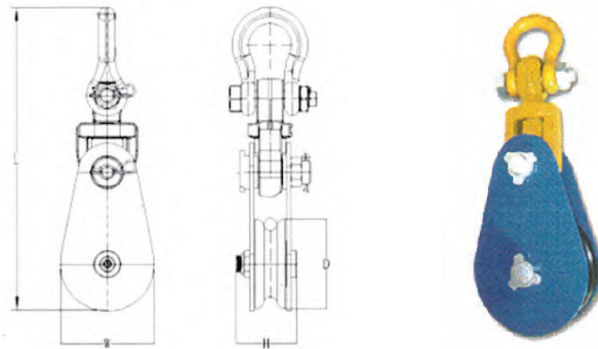

Size	Working Load Limit (T)	Sheave Diameter (in)	Wire Rope Size (mm)	Dimensions (mm)				Weight (kg)
				D	W	H	L	
6"x8T	8	6	16-19	152	155	90	495	13.6
6"x10T	10	6	16-19	152	155	95	520	15
8"x8T	8	8	20-22	202	205	103	560	19.3
10"x10T	10	10	24-26	254	260	115	679	35
10"x12T	12	10	24-26	254	260	115	685	40
10"x15T	15	10	24-26	254	260	135	713	54
10"x20T	20	10	25-26	254	257	150	777	56
12"x12T	12	12	24-26	304	307	133	767	56
12"x15T	15	12	24-26	304	307	135	788	58
12"x20T	20	12	25-29	304	307	150	833	62
14"x22T	22	14	29-32	355	360	140	952	112
16"x22T	22	16	29-32	406	410	140	1019	122
16"x30T	30	16	32-35	406	415	155	1128	164
20"x30T	30	20	32-35	508	515	184	1230	213
24"x50T	50	24	38-42	609	615	189	1330	340
30"x85T	85	30	46-50	762	765	236	1910	590
32"x100T	100	32	68-72	812	824	310	2100	650
35"x120T	120	35	78-82	889	900	330	2350	700

HY GENERAL BLOCK

- Key parts are forged bay alloy steel
- Assemble duplex rolling bearing, rotating more flexibly
- Fill with plenty of grease, lifetime increase 3 times or above



Type	Working Load (T)	Suitable Steel Wire Dia (mm)	Pulley Dia (mm)
HYG(L)K1-0.5	0.5	5-7	85
HYG(L)K1-1	1	7-11	105
HYG(L)K1-2	2	11-14	135
HYG(L)K1-3.2	3.2	12.5-15.5	160
HYG(L)K1-5	5	15.5-18.5	202
HYG(L)K1-8	8	20-23	260
HYG(L)K1-10	10	23-24.5	280
HYG(L)K1-16	16	28-31	345
HYG(L)K1-20	20	31-35	390
HY(HQ)G(L)k1-32	32	35-38	490
HY(HQ)G(L)k1-50	50	40-43	560

U.S TYPE FORGED TURNBUCKLE (HOOK & EYE HOOK & HOOK)

- Mild Steel



Size (in)	Dimensions (mm)			W. L. L. (lbs)	Weight (kg)
	A	B	C		
1/4×4	0.45	4.00	0.34	400	0.30
5/16×4 1/2	0.50	4.50	0.44	700	0.47
3/8×6	0.56	6.00	0.53	1000	0.75
1/2×6	0.66	6.00	0.72	1500	1.60
1/2×9	0.66	9.00	0.72	1500	1.83
1/2×12	0.66	12.00	0.72	1500	2.08
5/8×6	0.84	6.00	0.88	2250	2.75
5/8×9	0.84	9.00	0.88	2250	3.13
5/8×12	0.84	12.00	0.88	2250	3.50
3/4×6	0.98	6.00	1.00	3000	3.89
3/4×9	0.98	9.00	1.00	3000	4.61
3/4×12	0.98	12.00	1.00	3000	5.43
3/4×18	0.98	18.00	1.00	3000	7.25
7/8×12	1.13	12.00	1.25	4000	8.10
7/8×18	1.13	18.00	1.25	4000	9.98
1×6	1.25	6.0	1.44	5000	9.33
1×12	1.25	12.00	1.44	5000	11.93
1×18	1.25	18.00	1.44	5000	14.00
1×24	1.25	24.00	1.44	5000	17.25
1 1/4×12	1.50	12.00	1.81	6500	19.00
1 1/4×18	1.50	18.00	1.81	6500	23.00
1 1/4×24	1.50	24.00	1.81	6500	27.00
1 1/2×12	1.88	12.00	2.12	7500	27.50
1 1/2×18	1.88	18.00	2.12	7500	31.00
1 1/2×24	1.88	24.00	2.12	7500	37.50

U.S TYPE FORGED TURNBUCKLE (EYE & EYE, JAW & EYE, JAW & JAW)

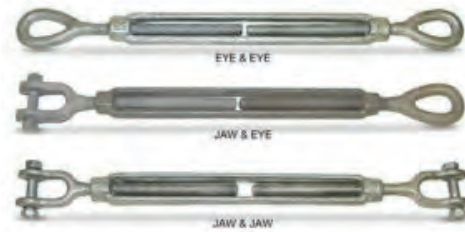

Size (in)	Dimensions (mm)				W. L. L. (lbs)	Weight (lbs) Eye/Eye	Weight (lbs) Jaw/Eye	Weight (kg)
	A	B	C	D				
1/4×4	0.45	0.62	0.78	0.34	500	0.30	0.32	0.39
5/16×4 1/2	0.50	0.87	0.94	0.44	800	0.46	0.47	0.54
3/8×6	0.54	0.87	1.12	0.53	1200	0.73	0.76	0.83
1/2×6	0.63	1.06	1.44	0.72	2200	1.48	1.53	1.57
1/2×9	0.55	1.06	1.44	0.72	2200	1.71	1.76	1.95
1/2×12	0.55	1.06	1.44	0.72	2200	2.19	2.20	2.24
5/8×6	0.82	1.31	1.75	0.88	3500	2.47	2.65	2.80
5/8×9	0.82	1.31	1.75	0.88	3500	2.90	3.06	3.35
5/8×12	0.82	1.31	1.75	0.88	3500	3.48	3.78	4.00
3/4×6	1.03	1.50	2.09	1.00	5200	3.90	4.00	4.30
3/4×9	1.03	1.50	2.09	1.00	5200	4.60	4.75	4.89
3/4×12	1.03	1.50	2.09	1.00	5200	5.46	5.76	5.90
3/4×18	1.03	1.50	2.09	1.00	5200	6.97	7.00	7.52
7/8×6	1.23	1.75	2.38	1.25	7200	5.85	6.29	6.84
7/8×12	1.23	1.75	2.38	1.25	7200	7.65	8.00	8.60
7/8×18	1.23	1.75	2.38	1.25	7200	10.25	10.60	11.44
1×6	1.31	2.06	3.00	1.44	10000	8.98	9.16	9.44
1×12	1.31	2.06	3.00	1.44	10000	11.31	11.40	11.53
1×18	1.31	2.06	3.00	1.44	10000	14.00	14.75	16.10
1×24	1.31	2.06	3.00	1.44	10000	16.02	17.50	18.60
1 1/4×6	1.86	2.81	3.56	1.81	15200	15.45	16.03	16.69
1 1/4×12	1.86	2.81	3.56	1.81	15200	19.00	20.00	23.00
1 1/4×18	1.86	2.81	3.56	1.81	15200	22.50	24.18	26.00
1 1/4×24	1.86	2.81	3.56	1.81	15200	25.00	28.50	31.20
1 1/2×12	2.25	2.81	4.06	2.12	21400	27.00	31.10	35.50
1 1/2×18	2.25	2.81	4.06	2.12	21400	31.69	35.00	40.70
1 1/2×24	2.25	2.81	4.06	2.12	21400	38.20	44.20	47.60
1 3/4×18	2.60	3.38	4.62	2.38	28000	45.20	48.80	52.40
1 3/4×24	2.60	3.38	4.62	2.38	28000	58.00	60.00	64.00
2×24	2.62	3.69	5.75	2.69	37000	81.57	102.00	115.00
2 1/2×24	3.06	4.44	6.50	3.12	60000	180.00	183.00	200.00
2 3/4×24	3.68	4.19	7.00	3.25	75000	210.00	214.00	248.00

TURNBUCKLE DIN 1480

• Mild Steel



Size (in)	Dimensions (mm)							Weight (kg)
	d2	e	f	h min	L2	m1	m2 max	
M6	12	19	9	6	110	12	6	0.86
M8	15	23	11	8	110	15	8	0.15
M10	18	30	14	9	125	18	9	0.28
M12	21	34	16	11	125	21	11	0.39
M16	27	42	20	14	170	27	14	0.90
M20	34	52	24	17	200	34	17	1.60
M24	39	60	28	20	255	39	20	2.70
M30	45	74	34	23	255	45	23	4.35
M36	55	86	40	28	255	55	28	7.50

TURNBUCKLE FRAME TYPE (FORGED STEEL)

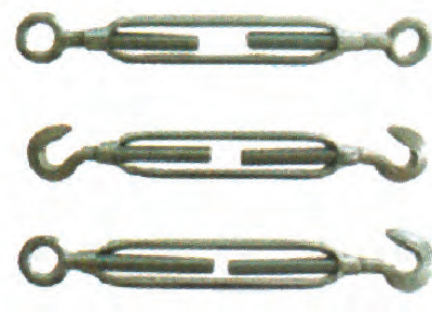
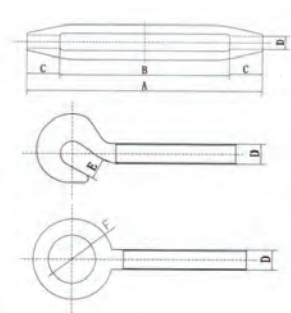

Size (in)	Dimensions (mm)						Eye and Eye		Hook and Eye		Hook and Hook	
	A	B	C	D	E	F	T.L (T)	Weight (Kg)	T.L (T)	Weight (Kg)	T.L (T)	Weight (Kg)
1/4	100	78	11	6	9	10	0.1	0.116	0.04	0.114	0.04	0.112
5/16	125	100	12.5	98	9	12	0.2	0.22	0.08	1.218	0.08	0.215
3/8	150	120	12.58	9	11	16	0.5	0.295	0.15	0.293	0.15	0.29
1/2	200	164	18	12	16	20	2	0.6	0.35	0.585	0.35	0.57
5/8	250	202	21.5	16	19	22	3	1.07	0.7	1.05	0.7	1.03
3/4	300	250	25	19	20	28	4	1.79	1.0	1.78	1.0	1.77
7/8	325	269	28	22	21	33	5	2.55	1.5	2.58	1.5	2.6
1	350	285	32.5	25	26	35	6	3.8	2.0	3.77	2.0	3.76
1 1/4	400	310	45	32	34	36	10	7.6	3.0	7.52	3.0	7.44

U.S. TYPE DROP FORGED STEEL WIRE ROPE CLIPS

• Mild Steel

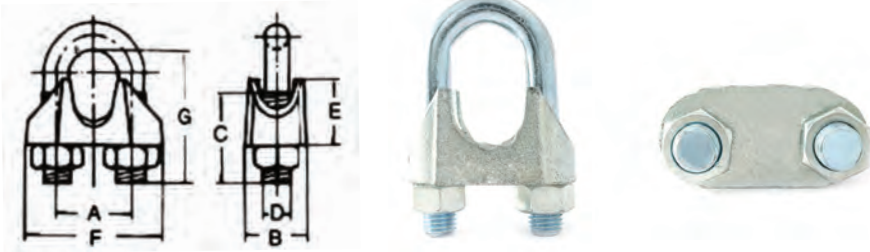

Size (in)	Dimensions (mm)							Weight (kg)
	D	C mm	A mm	G mm	F mm	B mm	E mm	
1/8	7/32	11	12	18	23	20	10	0.03
3/16	1/4	14	15	24	29	23	12	0.05
1/4	5/16	15	19	26	36	29	16	0.85
5/16	3/8	19	22	35	43	33	18	0.13
3/8	7/16	20	27.5	38	49	41	23	0.2
7/16	1/2	25	30	47	58	46	26	0.32
1/2	1/2	25	30	47	58	48	28	0.32
9/16	9/16	32	33	60	63	52	34	0.44
5/8	9/16	32	33	60	63	52	34	0.44
3/4	5/8	36	38	70	72	57	35	0.62
7/8	3/4	41	44	79	80	62	40	0.94
1	3/4	45	48	89	87	65	45	1.1
1 1/8	3/4	51	51	98	91	71	48	1.2
1 1/4	7/8	56	59	108	105	80	56	1.7
1 3/8	7/8	56	60	118	106	80	59	2
1 1/2	7/8	60	66	125	112	87	62	2.2
1 5/8	1	60	70	135	121	92	68	3.3
1 3/4	1 1/8	70	78	146	133	97	74	3.6
2	1 1/4	76	86	164	149	112	83	5.5
2 1/4	1 1/4	81	98	181	160	115	81	6.2
2 1/2	1 1/4	87	105	195	168	103	94	8
2 3/4	1 1/4	90	111	211	175	127	124	10.5
3	1 1/2	98	120	252	193	135	113	15
3 1/2	1 1/2	114	140	272	213	157	152	18

DIN1142 MALLEABLE WIRE ROPE CLIPS

• Mild Steel

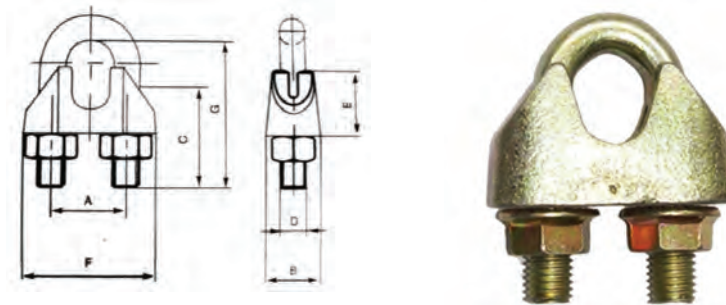

Size (in)	Dimensions (mm)							Weight (kg)
	A	B	C	D	E	F	G	
5	12	13	13	5	13	25	20	0.020
6.5	14	16	17	6	14	30	26	0.04
8	18	20	20	8	18	39	33	0.082
10	20	20	24	8	21	40	38	0.092
13	17	28	30	12	9	55	52	0.275
16	32	32	35	14	35	64	64	0.430
19	36	32	36	14	40	68	69	0.490
22	40	34	40	16	44	74	80	0.680
26	46	38	50	20	51	84	91	1.170
30	54	41	55	20	59	95	107	1.400
34	60	45	60	22	67	105	119	2.130
40	68	49	65	24	77	117	135	2.680

DIN741 MALLEABLE WIRE ROPE CLIPS

- Mild Steel

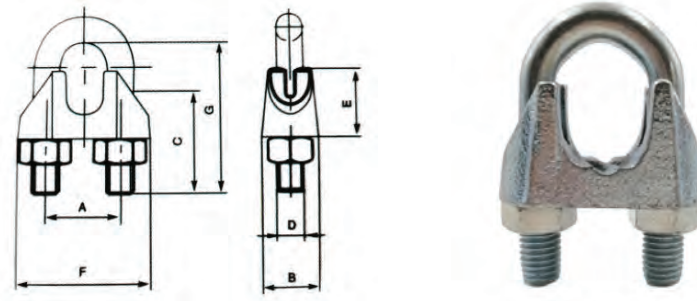

Size		Dimensions (mm)							Weight (kg)
in	mm	A	B	C	D	E	F	G	
1/8	3	9	10	12	4	10	21	16	0.008
3/16	5	11	11	13	5	10	23	19	0.013
1/4	6	13	12	15	5	11	26	23	0.015
5/16	8	16	14	19	6	15	30	28	0.025
3/8	10	19	18	22	8	17	34	34	0.055
7/16	11	20	19	22	8	18	36	36	0.055
1/2	13	24	23	30	10	21	42	45	0.105
9/16	14	25	23	30	10	22	44	47	0.11
5/8	16	29	26	33	12	26	50	51	0.17
3/4	19	32	29	38	12	30	54	63	0.21
7/8	22	37	33	44	14	34	61	71	0.32

U. S. TYPE MALLEABLE WIRE ROPE CLIPS

- Mild Steel

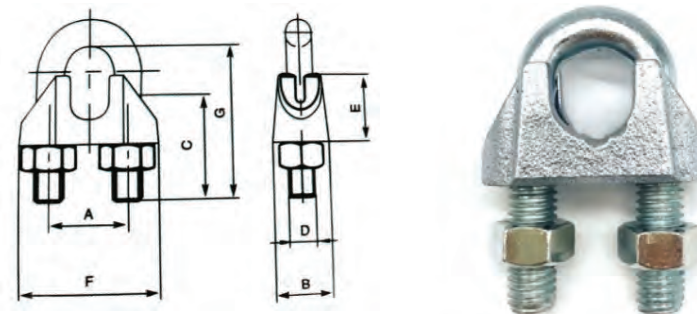

Size (in)	Dimensions (mm)							Weight (kg)
	A	B	C	D	E	F	G	
1/8	11	14	14	5	10.8	22	20	0.015
3/16	13.5	15	16	6	13	26	24	0.027
1/4	17	18.5	20	8	15	32	32.5	0.048
5/16	18.5	20	22	8	16	35	34	0.055
3/8	22.5	22	27	10	22	40.5	41.8	0.092
7/16	24	23	30	10	22	43	42.8	0.120
1/2	27	26	35	12	23.5	49	53.9	0.150
9/16	30	26.5	40	14	27	52.5	54.7	0.200
5/8	33	28.5	40	14	28	57.2	59.2	0.220
3/4	34.5	32	42	14	34	61	68.7	0.340
7/8	41	37	46	16	38	71	78	0.500
1	45.5	42	55	16	43	77.5	87.5	0.595

EYE SCREW DIN580

- Forged Carbon Steel

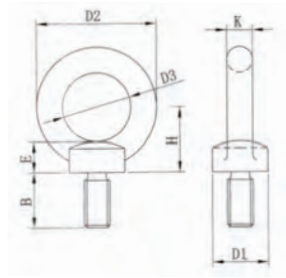

Size (mm)	Dimensions (mm)							90° W.L.L. (T)	0° W.L.L. (T)	Weight (kg/pc)
	D1	D2	D3	B	E	H	K			
M6	17.0	28.0	16.0	13.0	9.0	17.0	6.0	0.07	0.09	0.05
M8	20.0	36.0	20.0	13.0	8.0	18.0	8.0	0.095	0.14	0.06
M10	25.0	45.0	25.0	17.0	10.0	22.5	10.0	0.17	0.23	0.11
M12	30.0	54.0	30.0	20.5	11.0	26.0	12.0	0.24	0.34	0.18
M14	35.0	63.0	35.0	27.0	13.0	30.5	14.0	-	-	0.28
M16	35.0	63.0	35.0	27.0	13.0	30.5	14.0	0.50	0.70	0.28
M18	40.0	72.0	40.0	30.0	15.0	35.0	16.0	-	-	0.45
M20	40.0	72.0	40.0	30.0	15.0	35.0	16.0	0.83	1.20	0.45
M22	45.0	81.0	45.0	35.0	17.5	40.0	18.0	-	-	0.67
M24	50.0	90.0	50.0	36.0	20.0	45.0	20.0	1.27	1.80	0.78
M27	50.0	90.0	50.0	38.0	20.2	45.0	20.0	-	-	0.88
M30	65.0	108.0	60.0	45.0	25.0	55.0	24.0	2.60	3.60	1.66
M33	65.0	108.0	60.0	45.0	25.0	55.0	24.0	-	-	1.66
M36	75.0	126.0	70.0	54.0	30.0	65.0	28.0	3.70	5.10	2.65
M39	85.0	144.0	80.0	63.0	35.0	75.0	32.0	-	-	4.03
M42	85.0	144.0	80.0	63.0	35.0	75.0	32.0	5.00	7.00	4.03
M45	100.0	166.0	90.0	68.0	40.0	85.0	38.0	-	-	6.38
M48	100.0	166.0	90.0	68.0	40.0	85.0	38.0	6.10	8.60	6.38
M52	110.0	184.0	100.0	78.0	45.0	95.0	42.0	-	-	8.80
M56	110.0	184.0	100.0	78.0	45.0	95.0	42.0	8.30	11.50	8.80
M64	120.0	206.0	110.0	90.0	50.0	105.0	48.0	11.00	16.00	12.40
M72	150.0	260.0	140.0	100.0	60.0	130.0	60.0	15.00	21.00	23.30
M80	170.0	296.0	160.0	112.0	70.0	150.0	68.0	20.00	28.00	34.20
M100	190.0	330.0	180.0	130.0	75.0	165.0	75.0	27.00	38.00	49.10

RING NUT DIN582

• Forged Carbon Steel

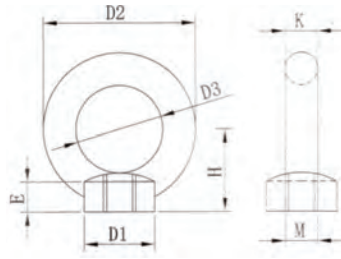

Size (mm)	Dimensions (mm)						90° W.L.L. (T)	0° W.L.L. (T)	Weight (kg/pc)
	D1	D2	D3	E	H	K			
M6	17.0	28.0	16.0	9.0	23.0	6.0	0.07	0.09	0.048
M8	20.0	36.0	20.0	8.0	26.0	8.0	0.095	0.14	0.05
M10	25.0	45.0	25.0	10.0	32.5	10.0	0.17	0.23	0.09
M12	30.0	54.0	30.0	11.0	38.0	12.0	0.24	0.34	0.16
M14	35.0	63.0	35.0	13.0	44.5	14.0	-	-	0.24
M16	35.0	63.0	35.0	13.0	44.5	14.0	0.50	0.70	0.24
M18	40.0	72.0	40.0	15.0	51.0	16.0	-	-	0.36
M20	40.0	72.0	40.0	15.0	51.0	16.0	0.83	1.20	0.36
M22	45.0	81.0	45.0	17.5	58.0	18.0	-	-	0.58
M24	50.0	90.0	50.0	20.0	65.0	20.0	1.27	1.80	0.72
M27	50.0	90.0	50.0	20.0	65.0	20.0	-	-	0.70
M30	65.0	108.0	60.0	25.0	79.0	24.0	2.60	3.60	1.32
M33	65.0	108.0	60.0	25.0	79.0	24.0	-	-	1.30
M36	75.0	126.0	70.0	30.0	93.0	28.0	3.70	5.10	2.08
M39	85.0	144.0	80.0	35.0	107.0	32.0	-	-	2.02
M42	85.0	144.0	80.0	35.0	107.0	32.0	5.00	7.00	3.11
M45	100.0	166.0	90.0	40.0	123.0	38.0	-	-	3.04
M48	100.0	166.0	90.0	40.0	123.0	38.0	6.10	8.60	5.02
M52	110.0	184.0	100.0	45.0	137.0	42.0	-	-	4.95
M56	110.0	184.0	100.0	45.0	137.0	42.0	8.30	11.5	6.69
M64	120.0	206.0	110.0	50.0	153.0	48.0	11.0	16.0	9.30
M2×6	150.0	260.0	140.0	60.0	190.0	60.0	15.0	21.0	18.75
M80×6	170.0	296.0	160.0	70.0	218.0	68.0	20.0	28.0	27.30
M100×6	190.0	330.0	180.0	75.0	240.0	75.0	27.0	38.0	36.40



View Catalogues



Visit Website

Design & Concept by: SGMCI/003/05/05/2026 | © MEGA LINK CHAINS (INDIA) LTD.



MEGA LINK CHAINS (INDIA) LTD.

Linking Safety, Strength & Reliability

Group of Companies

 MEGA LINK CHAINS (INDIA) LTD.	 MEGA & DELE (JINHUA) MACHINERY. CO. LTD.	 MEGALINK CHAINS LLC, USA	 MEGA LINK CHAINS GmbH, GERMANY
--	--	--	--



Wire Rope Division : J-64/4, Addl. Murbad, MIDC, Village Kudavali, Murbad, District, Thane, State: Maharashtra - 421401 India.

Chain Division : B 36/1 & B 38, Addl. Ambernath, Anand Nagar, MIDC, Ambernath (East), District, Thane, State: Maharashtra - 421506 India.

Corporate Office : Akshar Blue Chip IT Park, Plot No., D-263, Office No: 602, 6th Floor, Adjacent to Hotel Marriot, Turbhe, Navi Mumbai, State : Maharashtra - 400705. India.

+91-22-20870048 • +91-22-20870095 📠 +91-8100244446 • +91-9175230463

🌐 www.megalinkchains.com ✉ info@megalinkchains.com • sales@megalinkchains.com

do follow us on:   